



City of Westminster

Licensing Sub-Committee Report

| | |
|--------------------|---|
| Item No: | |
| Licensing Ref No: | 14/05061/LIPV |
| Date: | 9 October 2014 |
| Classification: | For General Release |
| Title of Report: | (Restaurant) 33 Dover Street London W1S 4NF |
| Report of: | Operational Director of Premises Management |
| Policy context: | City of Westminster Statement of Licensing Policy |
| Financial summary: | None |
| Report Author: | Mr Ryan Peermamode Environmental Health Case Officer (Licensing) |
| Contact Details: | Telephone: 020 7641 1879 E-mail: rpeermamode@westminster.gov.uk |

1. APPLICATION DETAILS

| | | | |
|--|--|-----------------------------------|---------------------------|
| Application Type: | Variation of the premises licence under the Licensing Act 2003. | | |
| Applicant: | Park Chinois Limited | Date Application Received: | 18 June 2014 |
| Premises Name and Address: | (Restaurant) 33 Dover Street, London, W1S 4NF | | |
| Ward Name: | West End | Stress Area: | No |
| Description of Premises: | The premises currently operates as a ground floor and basement restaurant and bar with associated regulated entertainment. | | |
| Description of variation: | <p>To vary the existing premises licence so as to:</p> <ol style="list-style-type: none"> 1. Vary the plans attached to the premises licence so as to: <ol style="list-style-type: none"> (i) Remove the basement level from the licensable area, and (ii) Incorporate changes to the ground floor, namely, reconfiguration of seating layout. 2. Remove conditions associated with the basement level, numbered, 12, 22, 23, 24, 26, 27 and 28. 3. Amend condition 16 so as to reduce capacity on the ground floor from 180 to 120, excluding staff. <p>A copy of the existing licence is shown at Appendix A1.</p> <p>The proposed variation is only to take effect on surrender of licence ref: 13/05090/LIPDPS for 17 Berkeley Street. A copy of this licence is shown at Appendix A2.</p> | | |
| Preliminary Note: | <p>This application should be read in conjunction with the New Premises Licence application for Park Chinois, 17 Berkeley Street (Ref: 14/05048/LIPN) at the licensing sub-committee hearing on 9th October.</p> <p>The New application for Park Chinois, 17 Berkeley Street seeks to incorporate the basement of 33 Dover Street into the licensable area of that premises licence.</p> | | |
| <i>Note: Where the committee is minded to grant the licence it will be granted subject to the mandatory conditions and conditions consistent with the operating schedule modified to such extent as the authority considers appropriate for the promotion of the licensing objectives detailed in Appendix D to this report.</i> | | | |
| Proposed Licensable Activities, Proposed Hours: | | | References / Notes |
| 1. | Variation to plans so as to: | | |
| | (i) Remove the basement level from the licensable area, and | | |
| | (ii) Incorporate changes to the ground floor, namely, reconfiguration of seating layout. | | |

Relevant representations and policies applicable:

| | |
|--|--|
| <p>1A An adverse representation has been made by the Police Licensing Team stating that the application if granted would undermine the crime prevention objective. Please refer to Appendix B1</p> | <p>Police; representation</p> |
| <p>1B An adverse representation has been made by the Environmental Health Service stating the granting of the application as presented would have the likely effect of causing an increase in public nuisance within the area and may impact upon public safety. Please refer to Appendix B2</p> | <p>Environmental Health; representation</p> |
| <p>1C Adverse representations were received from three residents of surrounding streets. The concerns raised refer to a public nuisance. However, two of the three representations have been withdrawn their representations following contact with the applicant. Please refer to Appendices B3-B5</p> | <p>1 Resident; representation</p> |
| <p>1D The following policies within the City Of Westminster Statement of Licensing Policy apply:</p> <p>Prevention of crime and disorder (CD1) Public Safety (PS1) Prevention of public nuisance (PN1) Protection children from harm (CH1) Hours (HRS1) Restaurants outside the Stress Areas (RNT1) Public houses and bars outside the Stress Areas (PB1) Provision of music and dancing outside the Stress Areas (MD1)</p> | <p>Policies applicable</p> |
| <p>1E Policy HRS1 applies:</p> <p>(i) Applications for hours within the core hours set out in this policy will generally be granted, subject to not being contrary to other policies in the Statement of Licensing Policy.</p> <p>(ii) Applications for hours outside the core hours in this policy will be considered on their merits, subject to other relevant policies and with particular regard to criteria set out in the policy.</p> | |
| <p>1F Policy RNT1 applies:</p> <p>Applications will generally be granted and reviews determined, subject to the relevant criteria in Policies CD1, PS1, PN1 and CH1.</p> | |
| <p>1G Policy PB1 applies:</p> <p>Applications will only be granted if it can be demonstrated that the proposal meets the relevant criteria in Policies CD1, PS1, PN1, CH1 and HRS1 and other policies in this statement.</p> | |
| <p>1H Policy MD1 applies:</p> <p>It is the Licensing Authority's policy that applications will only be granted if the proposal meets the relevant criteria in Polices CD1, PS1, PN1, and CH1.</p> | |
| <p>1I The Licensing Sub-committee may refuse, grant in full or grant in part this proposal, having taken into account the representations received and Westminster's Statement of Licensing Policy. The decision taken should promote the licensing objectives of:</p> | <p>Summary</p> |

- prevention of public nuisance,
- prevention of crime & disorder,
- public safety and
- protection of children from harm.

2. To remove conditions:-

12. *The entertainment in the basement shall be suitable to a light, sophisticated lounge bar environment. It shall not operate as a "disco" or night club with high noise levels.*
22. *The basement currently shown cross hatched on the plan shall not be used by any customer until the licensing authority are satisfied that the premises is constructed or altered in accordance with the appropriate provisions of the District Surveyor s Association Technical Standards for Places of Entertainment and the reasonable requirements of Westminster Environmental Health Consultation Team, at which time this condition will be removed from the Licence.*
23. *Before the basement opens to the public, the plans as deposited will be checked by the Environmental Health Consultation Team to ensure they are an accurate reflection of the premises constructed. Where the premises layout has changed during the course of construction new plans shall be provided to the Environmental Health Consultation Team and the Licensing Authority.*
24. *Whilst the toilets in the basement are not available, The temporary capacity for the ground floor of the premises shall be reduced to 120 (excluding staff) and condition 16 shall not apply until the works condition set out in 22 above is removed.*
26. *In the basement, between 07:00 - 10:00 and 02:00 - 03:00, alcohol will only be sold and supplied to persons attending pre-booked private events and shall be ancillary to the provision of music and dancing and substantial refreshment.*
27. *A booking sheet for each function will be made available to the police or an authorised officer of the council upon request at the premises. The booking sheet shall record the following information as a minimum - the name of the individual who has hired the premises together with contact details, date of hiring, and purpose of the event. A guest list for each event shall be made available for inspection.*
28. *No unauthorised advertisements of any kind (including placard, poster, sticker, flyer, picture, letter, sign or other mark) is inscribed or affixed upon the surface of the highway, or upon any building, structure, works, street furniture, tree, or any other property, or is distributed to the public, that advertises or promotes the establishment, its premises, or any of its events, facilities, goods or services.*

Relevant representations and policies applicable:

2A Please see paragraphs 1A to 1H.

**Opposed by
Police,
Environmental
Health & 1 Resident**

| | | |
|--|---|--|
| | <p>2B The Licensing Sub-committee may refuse, grant in full or grant in part this proposal, having taken into account the representations received and Westminster's Statement of Licensing Policy. The decision taken should promote the licensing objectives of:</p> <ul style="list-style-type: none"> ▪ prevention of public nuisance, ▪ prevention of crime & disorder, ▪ public safety and ▪ protection of children from harm. | Summary |
| <p>3.</p> | <p>To amend condition:-</p> <p>16. <i>The number of persons accommodated at any one time (excluding staff) shall not exceed: Ground Floor: <u>180</u>, Basement: <u>100</u></i></p> <p>To:</p> <p>16. <i>The number of customers accommodated at any one time (excluding staff) shall not exceed: Ground Floor: <u>120</u>.</i></p> <p>Relevant representations and policies applicable:</p> <p>3A Please see paragraphs 1A to 1H.</p> <p>3B The Licensing Sub-committee may refuse, grant in full or grant in part this proposal, having taken into account the representations received and Westminster's Statement of Licensing Policy. The decision taken should promote the licensing objectives of:</p> <ul style="list-style-type: none"> ▪ prevention of public nuisance, ▪ prevention of crime & disorder, ▪ public safety and ▪ protection of children from harm. | <p style="text-align: center;">Opposed by Police, Environmental Health & 1 Resident</p> <p style="text-align: center;">Summary</p> |
| <u>Existing Premises Licence</u> | | <u>Proposed Licensable Activities</u> |
| <p>Regulated Entertainment:</p> <p>Recorded Music Private Entertainment Monday to Sunday: Unrestricted</p> <p>Performance of Dance Live Music Anything of a similar description to Live Music, Recorded Music or Performance of Dance</p> <p>Ground Floor:- Monday to Saturday: 09:00 to 01:00</p> <p>Basement:- Monday to Friday 07:00 to 03:00 Saturday: 08:00 to 03:00 Sunday: 10:00 to 23:30 Sundays before Bank Holidays: 10:00 to 01:00</p> | | <p>Regulated Entertainment:</p> <p>No change</p> <p>Ground Floor: No change</p> <p>Basement: Removed</p> |

| | |
|---|--|
| <p>Late Night Refreshment:</p> <p>Ground Floor:- Monday to Saturday 23:00 to 02:00 Sunday: 23:00 to 23:30 Sundays before Bank Holidays: 23:00 to 01:00</p> <p>Basement:- Monday to Saturday 23:00 to 03:00 Sunday: 23:00 to 23:30 Sundays before Bank Holidays: 23:00 to 01:00</p> | <p>Late Night Refreshment:</p> <p>Ground Floor: No change</p> <p>Basement: Removed</p> |
| <p>Sale of Alcohol: On & Off Sales</p> <p>Ground Floor:- Monday to Friday 07:00 to 02:00 Saturday: 08:00 to 02:00 Sunday: 10:00 to 23:30 Sundays before Bank Holidays: 10:00 to 01:00</p> <p>Basement:- Monday to Friday 07:00 to 03:00 Saturday: 08:00 to 03:00 Sunday: 10:00 to 23:30 Sundays before Bank Holidays: 10:00 to 01:00</p> | <p>Sale of Alcohol: On & Off Sales</p> <p>Ground Floor: No change</p> <p>Basement: Removed</p> |
| <p>Capacity: Excluding staff</p> <p>Ground Floor: 180 Basement: 100</p> | <p>Capacity: Excluding staff</p> <p>Ground Floor: 120 Basement: Removed</p> |
| <p>Opening Hours:</p> <p>Monday to Friday 07:00 to 03:00 Saturday: 08:00 to 03:00 Sunday: 10:00 to 23:30 Sundays before Bank Holidays: 10:00 to 01:00</p> | <p>Opening Hours:</p> <p>No change</p> |
| <p>Non Standard Timings:</p> <p>From the end of permitted hours on New Year's Eve to the start of permitted hours on New Year's Day.</p> | <p>Non Standard Timings:</p> <p>No change</p> |
| <p>Current Licensing Position</p> | <p>The premises is currently licensed. Please refer to Appendix A1</p> |
| <p>Current Planning Position</p> | <p>The premises has long established use as a restaurant (Class A3).</p> |
| <p>Residential Density:</p> | <p>98 of the 247 units within a 75m radius of the premises are residential or proposed residential (40%). Please refer to Appendix E</p> |

| | |
|----------------------------------|---|
| List of Appendices: | A1 – Existing Licence A2 – Licence ref: 13/05090/LIPDPS (17 Berkeley Street) A3 – Application Form A4 – Plan B1 – Police Licensing Team; Representation B2 – Environmental Health Service; Representation B3 – Resident representations C – Premises Licence History D - Conditions E – Residential Map and list of premises in the vicinity F – Photos of premises |
| Relevant Representations: | Police Licensing Team Environmental Health Service 1 Resident objection |

2. APPLICANT SUBMISSIONS AND EVIDENCE

2.1 The evidence submitted by the applicant in support of the Licensing Objectives is provided in Appendix A.

3. LICENSING ACT 2003 APPLICATIONS AND APPEAL HISTORY

3.1 Any applications under the Licensing Act 2003 are set out in Appendix C

Background Documents – Local Government (Access to Information) Act 1972

- Licensing Act 2003
- City of Westminster Statement of Licensing Policy (7th January 2011)
- Amended Guidance issued under section 182 of the Licensing Act 2003 (June 2013)



Schedule 12
Part A

WARD: West End
UPRN: 010033533512

City of Westminster

64 Victoria Street, London, SW1E 6QP

Premises licence

Regulation 33, 34

Premises licence number:

13/05974/LIPVM

Original Reference:

05/06832/LIPCV

Part 1 – Premises details

Postal address of premises:

Automat
Basement And Ground Floor
33 Dover Street
London
W1S 4NF

Telephone Number: Not Supplied

Where the licence is time limited, the dates:

Not applicable

Licensable activities authorised by the licence:

Performance of Dance
Provision of facilities for Dancing
Provision of facilities for making Music
Performance of Live Music
Playing of Recorded Music
Provision of facilities for entertainment of a similar description to making music or dancing
Anything of a similar description to Live Music, Recorded Music or Performance of Dance
Late Night Refreshment
Private Entertainment consisting of dancing, music or other entertainment of a like kind for consideration and with a view to profit
Sale by Retail of Alcohol

The times the licence authorises the carrying out of licensable activities:

Performance of Dance

| | |
|-------------------------------|-------------------------------|
| Monday to Saturday: | 09:00 to 01:00 (Ground Floor) |
| Monday to Friday: | 07:00 to 03:00 (Basement) |
| Saturday: | 08:00 to 03:00 (Basement) |
| Sunday: | 10:00 to 23:30 (Basement) |
| Sundays before Bank Holidays: | 10:00 to 01:00 (Basement) |

Provision of facilities for Dancing

| | |
|-------------------------------|-------------------------------|
| Monday to Saturday: | 09:00 to 01:00 (Ground Floor) |
| Monday to Friday: | 07:00 to 03:00 (Basement) |
| Saturday: | 08:00 to 03:00 (Basement) |
| Sunday: | 10:00 to 23:30 (Basement) |
| Sundays before Bank Holidays: | 10:00 to 01:00 (Basement) |

Provision of facilities for making Music

| | |
|-------------------------------|-------------------------------|
| Monday to Saturday: | 09:00 to 01:00 (Ground Floor) |
| Monday to Friday: | 07:00 to 03:00 (Basement) |
| Saturday: | 08:00 to 03:00 (Basement) |
| Sunday: | 10:00 to 23:30 (Basement) |
| Sundays before Bank Holidays: | 10:00 to 01:00 (Basement) |

Performance of Live Music

| | |
|-------------------------------|-------------------------------|
| Monday to Saturday: | 09:00 to 01:00 (Ground Floor) |
| Monday to Friday: | 07:00 to 03:00 (Basement) |
| Saturday: | 08:00 to 03:00 (Basement) |
| Sunday: | 10:00 to 23:30 (Basement) |
| Sundays before Bank Holidays: | 10:00 to 01:00 (Basement) |

Playing of Recorded Music

Unrestricted

Provision of facilities for entertainment of a similar description to making music or dancing

| | |
|-------------------------------|-------------------------------|
| Monday to Saturday: | 09:00 to 01:00 (Ground Floor) |
| Monday to Friday: | 07:00 to 03:00 (Basement) |
| Saturday: | 08:00 to 03:00 (Basement) |
| Sunday: | 10:00 to 23:30 (Basement) |
| Sundays before Bank Holidays: | 10:00 to 01:00 (Basement) |

Anything of a similar description to Live Music, Recorded Music or Performance of Dance

| | |
|-------------------------------|-------------------------------|
| Monday to Saturday: | 09:00 to 01:00 (Ground Floor) |
| Monday to Friday: | 07:00 to 03:00 (Basement) |
| Saturday: | 08:00 to 03:00 (Basement) |
| Sunday: | 10:00 to 23:30 (Basement) |
| Sundays before Bank Holidays: | 10:00 to 01:00 (Basement) |

Late Night Refreshment

| | |
|-------------------------------|-------------------------------|
| Monday to Saturday: | 23:00 to 02:00 (Ground Floor) |
| Sunday: | 23:00 to 23:30 (Ground Floor) |
| Sundays before Bank Holidays: | 23:00 to 01:00 (Ground Floor) |
| Monday to Saturday: | 23:00 to 03:00 (Basement) |
| Sunday: | 23:00 to 23:30 (Basement) |
| Sundays before Bank Holidays: | 23:00 to 01:00 (Basement) |

Private Entertainment consisting of dancing, music or other entertainment of a like kind for consideration and with a view to profit

Unrestricted

Sale by Retail of Alcohol

| | |
|-------------------------------|-------------------------------|
| Monday to Friday: | 07:00 to 02:00 (Ground Floor) |
| Saturday: | 08:00 to 02:00 (Ground Floor) |
| Sunday: | 10:00 to 23:30 (Ground Floor) |
| Sundays before Bank Holidays: | 10:00 to 01:00 (Ground Floor) |
| Monday to Friday: | 07:00 to 03:00 (Basement) |
| Saturday: | 08:00 to 03:00 (Basement) |
| Sunday: | 10:00 to 23:30 (Basement) |
| Sundays before Bank Holidays: | 10:00 to 01:00 (Basement) |

For times authorised for New Year see conditions at Annex 1

The opening hours of the premises:

| | |
|-------------------------------|----------------|
| Monday to Friday: | 07:00 to 03:00 |
| Saturday: | 08:00 to 03:00 |
| Sunday: | 10:00 to 23:30 |
| Sundays before Bank Holidays: | 10:00 to 01:00 |

Where the licence authorises supplies of alcohol, whether these are on and/or off supplies:

Alcohol is supplied for consumption both on and off the Premises.

Part 2

Name, (registered) address, telephone number and email (where relevant) of holder of premises licence:

Park Chinois Limited
Basement And Ground Floor
12 Princes Street
London
W1B 2LL
Electronic Mail : secl1c1@jgrlaw.co.uk
Business Phone Number : 0207 025 8332

Registered number of holder, for example company number, charity number (where applicable)

07902469

Name, address and telephone number of designated premises supervisor where the premises licence authorises the supply of alcohol:

Name: Mr Mark Belton

Please note: It is the policy of the Licensing Authority not to display the address details of a designated premises supervisor.

Personal licence number and issuing authority of personal licence held by designated premises supervisor where the premises licence authorises for the supply of alcohol:

Licence Number: LEW0767
Licensing Authority: London Borough Of Lewisham

Date: _____ 1st October 2013 _____

Signed: pp
Operational Director - Premises Management

Annex 1 – Mandatory conditions

1. No supply of alcohol may be made at a time when there is no designated premises supervisor in respect of this licence.
2. No supply of alcohol may be made at a time when the designated premises supervisor does not hold a personal licence or the personal licence is suspended.
3. Every supply of alcohol under this licence must be made or authorised by a person who holds a personal licence.
4.
 - (1) The responsible person shall take all reasonable steps to ensure that staff on relevant premises do not carry out, arrange or participate in any irresponsible promotions in relation to the premises.
 - (2) In this paragraph, an irresponsible promotion means any one or more of the following activities, or substantially similar activities, carried on for the purpose of encouraging the sale or supply of alcohol for consumption on the premises in a manner which carries a significant risk of leading or contributing to crime and disorder, prejudice to public safety, public nuisance, or harm to children
 - (a) games or other activities which require or encourage, or are designed to require or encourage, individuals to
 - (i) drink a quantity of alcohol within a time limit (other than to drink alcohol sold or supplied on the premises before the cessation of the period in which the responsible person is authorised to sell or supply alcohol), or
 - (ii) drink as much alcohol as possible (whether within a time limit or otherwise);
 - (b) provision of unlimited or unspecified quantities of alcohol free or for a fixed or discounted fee to the public or to a group defined by a particular characteristic (other than any promotion or discount available to an individual in respect of alcohol for consumption at a table meal, as defined in section 159 of the Act);
 - (c) provision of free or discounted alcohol or any other thing as a prize to encourage or reward the purchase and consumption of alcohol over a period of 24 hours or less;
 - (d) provision of free or discounted alcohol in relation to the viewing on the premises of a sporting event, where that provision is dependent on
 - (i) the outcome of a race, competition or other event or process, or
 - (ii) the likelihood of anything occurring or not occurring;
 - (e) selling or supplying alcohol in association with promotional posters or flyers on, or in the vicinity of, the premises which can reasonably be considered to condone, encourage or glamorise anti-social behaviour or to refer to the effects of drunkenness in any favourable manner.
5. The responsible person shall ensure that no alcohol is dispensed directly by one person into the mouth of another (other than where that other person is unable to drink without assistance by reason of a disability).
6. The responsible person shall ensure that free tap water is provided on request to customers where it is reasonably available.
7.
 - (1) The premises licence holder or club premises certificate holder shall ensure that an age verification policy applies to the premises in relation to the sale or supply of alcohol.

- (2) The policy must require individuals who appear to the responsible person to be under 18 years of age (or such older age as may be specified in the policy) to produce on request, before being served alcohol, identification bearing their photograph, date of birth and a holographic mark.

8. The responsible person shall ensure that

- (a) where any of the following alcoholic drinks is sold or supplied for consumption on the premises (other than alcoholic drinks sold or supplied having been made up in advance ready for sale or supply in a securely closed container) it is available to customers in the following measures
 - (i) beer or cider: ½ pint;
 - (ii) gin, rum, vodka or whisky: 25 ml or 35 ml; and
 - (iii) still wine in a glass: 125 ml; and
- (b) customers are made aware of the availability of these measures.

A responsible person in relation to a licensed premises means the holder of the premise licence in respect of the premises, the designated premises supervisor (if any) or any individual aged 18 or over who is authorised by either the licence holder or designated premises supervisor. For premises with a club premises certificate, any member or officer of the club present on the premises in a capacity that which enables him to prevent the supply of alcohol.

9. All persons guarding premises against unauthorised access or occupation or against outbreaks of disorder or against damage (door supervisors) must be licensed by the Security Industry Authority.

Conditions reproducing the effect of conditions subject to which the relevant existing licences have effect.

Conditions relating to Regulated Entertainment:

10. This licence is subject to all the former Rules of Management for Places of Public Entertainment licensed by Westminster City Council, in force from 4 September 1998 and incorporating amendments agreed by the Council on 25 October 1999, 30 June 2000, 16 January 2001 and 1 October 2001.
11. On New Year's Eve the premises can remain open for the purpose of providing regulated entertainment from the time when the provision of regulated entertainment must otherwise cease on New Year's Eve to the time when regulated entertainment can commence on New Year's Day (or until midnight on New Year's Eve where no regulated entertainment takes place on New Year's Day).
12. The entertainment in the basement shall be suitable to a light, sophisticated lounge bar environment. It shall not operate as a "disco" or night club with high noise levels.
13. No additional sound generating equipment shall be used at the premises without being routed through the sound limiter device.
14. No doors giving access/egress to the premises shall be fixed open after 11pm.
15. The licensee shall use his best endeavours to discourage patrons from using unlicensed minicabs.
16. The number of persons accommodated at any one time (excluding staff) shall not exceed: Ground Floor: 180, Basement: 100

Conditions for Sale of Alcohol

17. Substantial food and suitable beverages other than intoxicating liquor (including drinking water) shall be available during the whole of the permitted hours in all parts of the premises where intoxicating liquor is sold or supplied.
18. A closed circuit television system shall be installed, maintained and operated correctly as specified by the Metropolitan Police Crime prevention Officer.

Conditions which reproduce the effect of any restriction imposed on the use of the premises by specified enactments.

19. The permitted hours on New Year's Eve for the sale of alcohol will extend to the start of permitted hours on the following day.
20. If any entertainment is provided for children or if an entertainment is provided at which the majority of persons attending are children, then, if the number of children attending the entertainment exceeds 100, it shall be the duty of the holder of this premises licence/club certificate:
 - a) to station and keep stationed wherever necessary a sufficient number of adult attendants, properly instructed as to their duties, to prevent more children or other persons being admitted to the building, or to any part thereof, than the building or part can properly accommodate,
 - b) to control the movement of the children and other persons admitted while entering and leaving the building or any part thereof, and
 - c) to take all other reasonable precautions for the safety of the children.
21. The terminal hour for late night refreshment on New Year's Eve is extended to 05:00 on New Year's Day.

Annex 2 – Conditions consistent with the operating Schedule

22. The basement currently shown cross hatched on the plan shall not be used by any customer until the licensing authority are satisfied that the premises is constructed or altered in accordance with the appropriate provisions of the District Surveyor s Association Technical Standards for Places of Entertainment and the reasonable requirements of Westminster Environmental Health Consultation Team, at which time this condition will be removed from the Licence.
23. Before the basement opens to the public, the plans as deposited will be checked by premises constructed. Where the premises layout has changed during the course of construction new plans shall be provided to the Environmental Health Consultation Team and the Licensing Authority.
24. Whilst the toilets in the basement are not available, The temporary capacity for the ground floor of the premises shall be reduced to 120 (excluding staff) and condition 16 shall not apply until the works condition set out in 22 above is removed.

Annex 3 – Conditions attached after a hearing by the licensing authority

Ground floor

25. Between 07:00 - 10:00 and 01:00 - 02:00 the sale and supply of alcohol shall be ancillary to persons taking a table meal.

Basement

26. In the basement, between 07:00 - 10:00 and 02:00 - 03:00, alcohol will only be sold and supplied to persons attending pre-booked private events and shall be ancillary to the provision of music and dancing and substantial refreshment.
27. A booking sheet for each function will be made available to the police or an authorised officer of the council upon request at the premises. The booking sheet shall record the following information as a minimum - the name of the individual who has hired the premises together with contact details, date of hiring, and purpose of the event. A guest list for each event shall be made available for inspection.
28. No unauthorised advertisements of any kind (including placard, poster, sticker, flyer, picture, letter, sign or other mark) is inscribed or affixed upon the surface of the highway, or upon any building, structure, works, street furniture, tree, or any other property, or is distributed to the public, that advertises or promotes the establishment, its premises, or any of its events, facilities, goods or services.

Both floors

29. No noise shall emanate from the premises nor vibration be transmitted through the structure of the premises which gives rise to a nuisance.
30. No person under 14 shall be admitted to the premises save in the company of an adult.
31. An itemised bill shall be provided to all customers paying by credit card.
32. The SIA registered door supervisor shall at all times monitor the activity of customers who are outside the premises eg to smoke, and encourage them to return inside.
33. The SIA registered door supervisor shall at all times monitor the activity of persons leaving the premises and when appropriate remind them to respect the needs of local residents and not to loiter outside the premises.
34. No deliveries to the premises shall take place between 23:00 hours and 07:15 hours except bread between 06:30 and 07:15.
35. No refuse collections shall take place before 07:30.
36. No noise nuisance shall be caused to local residents from the operation of any plant associated with the kitchen duct/extract fan system.
37. Notices shall be clearly and prominently displayed at all exits informing customers that this is a residential area and requiring customers to leave the premises quietly and not to loiter outside the premises.
38. A sound limiting device located in a separate and remote lockable cabinet from the volume control shall be fitted to any musical amplification system and set at a level determined by and to the satisfaction of an authorised officer of the Environmental Health Service's Community Protection Department in conjunction with local residents to ensure that no noise nuisance is caused to local residents. The

operational panel of the noise limiter shall then be secured to the satisfaction of officer from the Environmental Health Service. The keys securing the noise limiter cabinet shall be held by the licence holder or authorised manager only, and shall not be accessed by any other person. The limiter shall not be altered without prior agreement with the Environmental Health Service.

39. After 9pm on each day when the premises is open, at least 1 clearly identified SIA registered door supervisors shall be on duty at each entrance in use at the premises whilst the premises are open to the public.
40. There shall be no entry/re-entry to the premises after 01:00am when no Regulated Entertainment and after 2am when Regulated Entertainment is taking place.
41. All windows on all floors and external doors shall be kept closed after 9pm, or at all times when regulated entertainment is provided, except for the immediate access and egress of customers.
42. The licence holder shall enter into an agreement with a hackney carriage and/or private carriage firm to provide transport for customers, with contact numbers made readily available to customers, who will be encouraged to use such services and required to remain inside the premises while waiting for the vehicle to arrive at the premises.
43. Patrons permitted to temporarily leave and re-enter the premises eg to smoke shall be limited to a maximum of 7 persons at any one time.
44. No waste or recyclable materials, including bottles, shall be moved, removed or placed in outside areas between 23:00 hours and 07:30 hours.
45. Patrons permitted to temporarily leave and re-enter the premises eg to smoke shall not be permitted to take drinks or glass containers with them
46. Notices shall be prominently displayed in any area used for smoking requesting patrons respect the needs of local residents and use the area quietly.
47. All waste shall be properly presented and placed out for collection no earlier than 30 minutes before the scheduled collection time.
48. The pavement from the building line to the kerb edge immediately outside the premises, including gutter/channel at its junction with the kerb edge, shall be swept and/or washed daily, and litter and sweepings collected.
49. Rubber or Felt pads shall be attached to the legs / feet of all furniture in the ground floor restaurant.
50. Loudspeakers shall not be located in the entrance lobby or outside the premises building.
51. All sales of alcohol for consumption off the premises shall be in sealed containers only, and shall not be consumed on the premises or in the immediate vicinity.
52. The Premises Licence Holder shall employ the services of a competent acoustic consultant to carry out a survey of the premises to determine:
 - o Transmission of structure borne noise
 - o Noise breakout
 - o Noise transmission through building services into adjoining commercial and residential property

- o A noise report of the findings of the survey shall be produced identifying sound insulation and sound reduction measures, conclusions, recommendations and time scales.
- o A copy of the noise report shall be submitted to the Environmental Health Service Consultation team for comment prior to any major work being carried out.

Conditions a) and b) listed below will apply until any recommended attenuation work has been carried out and this condition has been removed from the licence.

- a) General routine cleaning of the ground floor restaurant shall only take place between the hours of 06:00 and 23:00 hours (this does not include cleaning in response to spillages and non-routine functions); no cleaning machinery to be used before 07:00.
 - b) Regulated entertainment shall not take place in the ground floor of the premises.
53. Arrangements be made by the licensee to invite local residents to meetings, not less than quarterly, to discuss issues related to the premises.

Annex 4 – Plans

Attached

Removal of bar

New kitchen

1
Ground Level
1 : 100

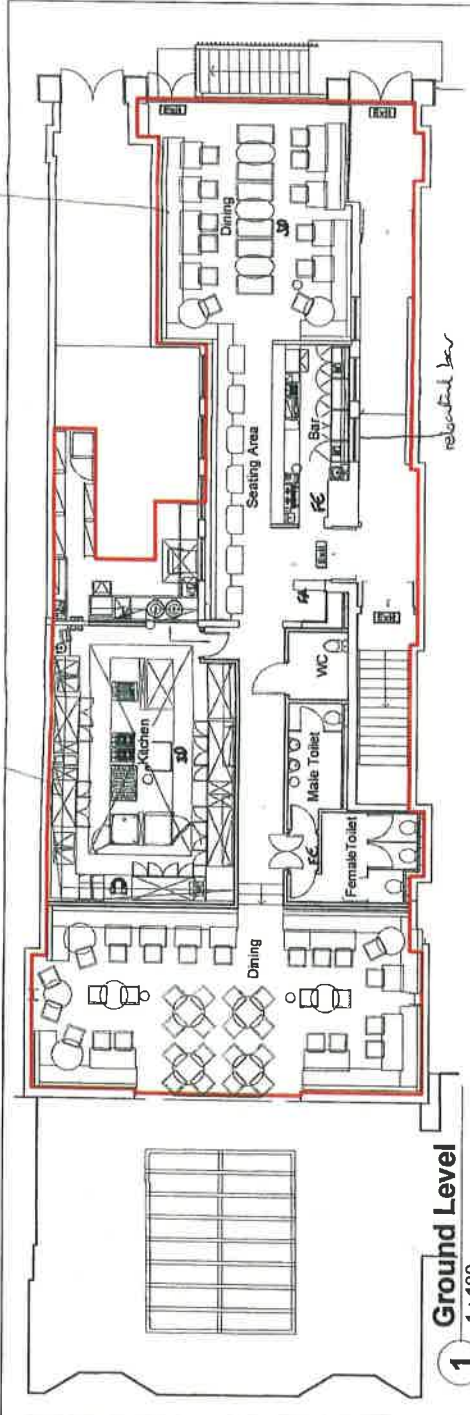

2
Basement Level
1 : 100

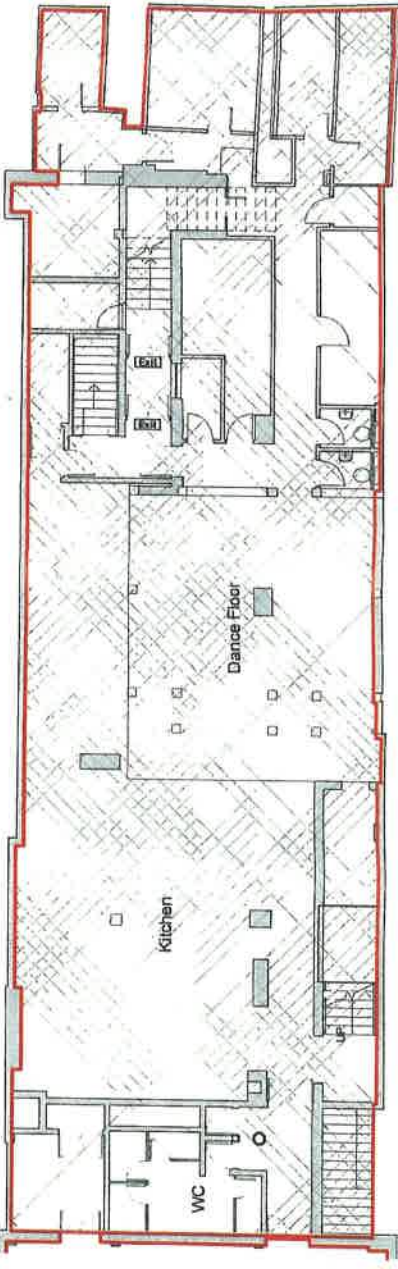

FE = Fire Extinguisher
 SD = Smoke Detector
 FIRE EXIT
 PA = FIRE RALLY

2
Basement Level
1 : 100

project Washing Potato-33 Dover Street
 title Ground and Basement Level Plans
 drawing no 07/2013
 scale 1 : 100 @ A3
 number 4305 LL.00.01



LIQUOR LICENSE APPLICATION

Licensable activities may take place anywhere within the red line. The position of any loose furniture is shown for diagrammatic purposes only. The location of fire equipment is shown as is on the date hereof but may be moved in consultation with the fire officer.

Dated: 7 August 2013



Schedule 12
Part B

WARD: West End
UPRN: 010033533512

City of Westminster
64 Victoria Street, London, SW1E 6QP

**Premises licence
summary**

Regulation 33, 34

Premises licence number:

13/05974/LIPVM

Part 1 – Premises details

Postal address of premises:

Automat
Basement And Ground Floor
33 Dover Street
London
W1S 4NF

Telephone Number: Not Supplied

Where the licence is time limited, the dates:

Not applicable

Licensable activities authorised by the licence:

Performance of Dance
Provision of facilities for Dancing
Provision of facilities for making Music
Performance of Live Music
Playing of Recorded Music
Provision of facilities for entertainment of a similar description to making music or dancing
Anything of a similar description to Live Music, Recorded Music or Performance of Dance
Late Night Refreshment
Private Entertainment consisting of dancing, music or other entertainment of a like kind for consideration and with a view to profit
Sale by Retail of Alcohol

The times the licence authorises the carrying out of licensable activities:

Performance of Dance

| | |
|-------------------------------|-------------------------------|
| Monday to Saturday: | 09:00 to 01:00 (Ground Floor) |
| Monday to Friday: | 07:00 to 03:00 (Basement) |
| Saturday: | 08:00 to 03:00 (Basement) |
| Sunday: | 10:00 to 23:30 (Basement) |
| Sundays before Bank Holidays: | 10:00 to 01:00 (Basement) |

Provision of facilities for Dancing

| | |
|---------------------|-------------------------------|
| Monday to Saturday: | 09:00 to 01:00 (Ground Floor) |
| Monday to Friday: | 07:00 to 03:00 (Basement) |
| Saturday: | 08:00 to 03:00 (Basement) |
| Sunday: | 10:00 to 23:30 (Basement) |

Sundays before Bank Holidays: 10:00 to 01:00 (Basement)

Provision of facilities for making Music

Monday to Saturday: 09:00 to 01:00 (Ground Floor)
Monday to Friday: 07:00 to 03:00 (Basement)
Saturday: 08:00 to 03:00 (Basement)
Sunday: 10:00 to 23:30 (Basement)
Sundays before Bank Holidays: 10:00 to 01:00 (Basement)

Performance of Live Music

Monday to Saturday: 09:00 to 01:00 (Ground Floor)
Monday to Friday: 07:00 to 03:00 (Basement)
Saturday: 08:00 to 03:00 (Basement)
Sunday: 10:00 to 23:30 (Basement)
Sundays before Bank Holidays: 10:00 to 01:00 (Basement)

Playing of Recorded Music Unrestricted

Provision of facilities for entertainment of a similar description to making music or dancing

Monday to Saturday: 09:00 to 01:00 (Ground Floor)
Monday to Friday: 07:00 to 03:00 (Basement)
Saturday: 08:00 to 03:00 (Basement)
Sunday: 10:00 to 23:30 (Basement)
Sundays before Bank Holidays: 10:00 to 01:00 (Basement)

Anything of a similar description to Live Music, Recorded Music or Performance of Dance

Monday to Saturday: 09:00 to 01:00 (Ground Floor)
Monday to Friday: 07:00 to 03:00 (Basement)
Saturday: 08:00 to 03:00 (Basement)
Sunday: 10:00 to 23:30 (Basement)
Sundays before Bank Holidays: 10:00 to 01:00 (Basement)

Late Night Refreshment

Monday to Saturday: 23:00 to 02:00 (Ground Floor)
Sunday: 23:00 to 23:30 (Ground Floor)
Sundays before Bank Holidays: 23:00 to 01:00 (Ground Floor)
Monday to Saturday: 23:00 to 03:00 (Basement)
Sunday: 23:00 to 23:30 (Basement)
Sundays before Bank Holidays: 23:00 to 01:00 (Basement)

Private Entertainment consisting of dancing, music or other entertainment of a like kind for consideration and with a view to profit Unrestricted

Sale by Retail of Alcohol

Monday to Friday: 07:00 to 02:00 (Ground Floor)
Saturday: 08:00 to 02:00 (Ground Floor)
Sunday: 10:00 to 23:30 (Ground Floor)
Sundays before Bank Holidays: 10:00 to 01:00 (Ground Floor)
Monday to Friday: 07:00 to 03:00 (Basement)
Saturday: 08:00 to 03:00 (Basement)
Sunday: 10:00 to 23:30 (Basement)
Sundays before Bank Holidays: 10:00 to 01:00 (Basement)

For times authorised for New Year see conditions at Annex 1

The opening hours of the premises:

| | |
|-------------------------------|----------------|
| Monday to Friday: | 07:00 to 03:00 |
| Saturday: | 08:00 to 03:00 |
| Sunday: | 10:00 to 23:30 |
| Sundays before Bank Holidays: | 10:00 to 01:00 |

Where the licence authorises supplies of alcohol, whether these are on and/or off supplies:

Alcohol is supplied for consumption both on and off the Premises.

Name and (registered) address of holder of premises licence:

Park Chinois Limited
Basement And Ground Floor
12 Princes Street
London
W1B 2LL

Registered number of holder, for example company number, charity number (where applicable)

07902469

Name of designated premises supervisor where the premises licence authorises for the supply of alcohol:

Name: Mr Mark Belton

State whether access to the premises by children is restricted or prohibited:

Restricted

Date: _____ 1st October 2013 _____

Signed: pp
Operational Director - Premises Management



Schedule 12
Part A

WARD: West End
UPRN: 010033540857

City of Westminster

64 Victoria Street, London, SW1E 6QP

Premises licence

Regulation 33, 34

Premises licence number:

13/05090/LIPDPS

Original Reference:

05/10486/LIPN

Part 1 – Premises details

Postal address of premises:

Manray
Basement And Ground Floor
17 Berkeley Street
London
W1J 8EA

Telephone Number: 0207 025 8332

Where the licence is time limited, the dates:

Not applicable

Licensable activities authorised by the licence:

Performance of Dance
Provision of facilities for Dancing
Exhibition of a Film
Provision of facilities for making Music
Performance of Live Music
Playing of Recorded Music
Provision of facilities for entertainment of a similar description to making music or dancing
Anything of a similar description to Live Music, Recorded Music or Performance of Dance
Late Night Refreshment
Sale by Retail of Alcohol

The times the licence authorises the carrying out of licensable activities:

Performance of Dance

| | |
|---------------------|---------------------------|
| Monday to Thursday: | 09:00 to 23:30 (Basement) |
| Friday to Saturday: | 09:00 to 00:00 (Basement) |
| Sunday: | 09:00 to 22:30 (Basement) |

Provision of facilities for Dancing

| | |
|---------------------|---------------------------|
| Monday to Thursday: | 09:00 to 23:30 (Basement) |
| Friday to Saturday: | 09:00 to 00:00 (Basement) |
| Sunday: | 09:00 to 22:30 (Basement) |

Exhibition of a Film

| | |
|---------------------|---|
| Monday to Thursday: | 09:00 to 23:30 (Basement and Ground Floors) |
| Friday to Saturday: | 09:00 to 00:00 (Basement and Ground Floors) |
| Sunday: | 09:00 to 22:30 (Basement and Ground Floors) |

Provision of facilities for making Music

Monday to Thursday: 09:00 to 23:30 (Basement)
Friday to Saturday: 09:00 to 00:00 (Basement)
Sunday: 09:00 to 22:30 (Basement)

Performance of Live Music

Monday to Thursday: 09:00 to 23:30 (Basement)
Friday to Saturday: 09:00 to 00:00 (Basement)
Sunday: 09:00 to 22:30 (Basement)

Playing of Recorded Music

Monday to Thursday: 09:00 to 23:30 (Basement and Ground Floors)
Friday to Saturday: 09:00 to 00:00 (Basement and Ground Floors)
Sunday: 09:00 to 22:30 (Basement and Ground Floors)

Provision of facilities for entertainment of a similar description to making music or dancing

Monday to Thursday: 09:00 to 23:30 (Basement)
Friday to Saturday: 09:00 to 00:00 (Basement)
Sunday: 09:00 to 22:30 (Basement)

Anything of a similar description to Live Music, Recorded Music or Performance of Dance

Monday to Thursday: 09:00 to 23:30 (Basement)
Friday to Saturday: 09:00 to 00:00 (Basement)
Sunday: 09:00 to 22:30 (Basement)

Late Night Refreshment

Monday to Thursday: 23:00 to 23:30 (Basement and Ground Floors)
Friday to Saturday: 23:00 to 00:00 (Basement and Ground Floors)

Sale by Retail of Alcohol

Monday to Thursday: 10:00 to 23:30 (Basement and Ground Floors)
Friday to Saturday: 10:00 to 00:00 (Basement and Ground Floors)
Sunday: 12:00 to 22:30 (Basement and Ground Floors)

The opening hours of the premises:

Monday to Sunday: 07:00 to 06:00

Where the licence authorises supplies of alcohol, whether these are on and/or off supplies:

Alcohol is supplied for consumption both on and off the Premises.

Part 2**Name, (registered) address, telephone number and email (where relevant) of holder of premises licence:**

Blake Trading Limited
12 Princes Street
London
W1B 2LL
Electronic Mail : c/o_lana@lflaw.co.uk

Registered number of holder, for example company number, charity number (where applicable)

07902469

Name, address and telephone number of designated premises supervisor where the premises licence authorises the supply of alcohol:

Name: Mr Mark Belton

Please note: It is the policy of the Licensing Authority not to display the address details of a designated premises supervisor.

Personal licence number and issuing authority of personal licence held by designated premises supervisor where the premises licence authorises for the supply of alcohol:

Licence Number: LEW0767

Licensing Authority: London Borough Of Lewisham

Date: 26 July 2013

Signed: pp

Operational Director - Premises Management

Annex 1 – Mandatory conditions

1. No supply of alcohol may be made at a time when there is no designated premises supervisor in respect of this licence.
2. No supply of alcohol may be made at a time when the designated premises supervisor does not hold a personal licence or the personal licence is suspended.
3. Every supply of alcohol under this licence must be made or authorised by a person who holds a personal licence.
- 4.— (1) The responsible person shall take all reasonable steps to ensure that staff on relevant premises do not carry out, arrange or participate in any irresponsible promotions in relation to the premises.

(2) In this paragraph, an irresponsible promotion means any one or more of the following activities, or substantially similar activities, carried on for the purpose of encouraging the sale or supply of alcohol for consumption on the premises in a manner which carries a significant risk of leading or contributing to crime and disorder, prejudice to public safety, public nuisance, or harm to children—
 - (a) games or other activities which require or encourage, or are designed to require or encourage, individuals to—
 - (i) drink a quantity of alcohol within a time limit (other than to drink alcohol sold or supplied on the premises before the cessation of the period in which the responsible person is authorised to sell or supply alcohol), or
 - (ii) drink as much alcohol as possible (whether within a time limit or otherwise);
 - (b) provision of unlimited or unspecified quantities of alcohol free or for a fixed or discounted fee to the public or to a group defined by a particular characteristic (other than any promotion or discount available to an individual in respect of alcohol for consumption at a table meal, as defined in section 159 of the Act);
 - (c) provision of free or discounted alcohol or any other thing as a prize to encourage or reward the purchase and consumption of alcohol over a period of 24 hours or less;
 - (d) provision of free or discounted alcohol in relation to the viewing on the premises of a sporting event, where that provision is dependent on—
 - (i) the outcome of a race, competition or other event or process, or
 - (ii) the likelihood of anything occurring or not occurring;
 - (e) selling or supplying alcohol in association with promotional posters or flyers on, or in the vicinity of, the premises which can reasonably be considered to condone, encourage or glamorise anti-social behaviour or to refer to the effects of drunkenness in any favourable manner.
5. The responsible person shall ensure that no alcohol is dispensed directly by one person into the mouth of another (other than where that other person is unable to drink without assistance by reason of a disability).

6. The responsible person shall ensure that free tap water is provided on request to customers where it is reasonably available.

7. (1) The premises licence holder or club premises certificate holder shall ensure that an age verification policy applies to the premises in relation to the sale or supply of alcohol.

(2) The policy must require individuals who appear to the responsible person to be under 18 years of age (or such older age as may be specified in the policy) to produce on request, before being served alcohol, identification bearing their photograph, date of birth and a holographic mark.

8. The responsible person shall ensure that—
 - (a) where any of the following alcoholic drinks is sold or supplied for consumption on the premises (other than alcoholic drinks sold or supplied having been made up in advance ready for sale or supply in a securely closed container) it is available to customers in the following measures—
 - (i) beer or cider: ½ pint;
 - (ii) gin, rum, vodka or whisky: 25 ml or 35 ml; and
 - (iii) still wine in a glass: 125 ml; and

 - (b) customers are made aware of the availability of these measures.

A responsible person in relation to a licensed premises means the holder of the premise licence in respect of the premises, the designated premises supervisor (if any) or any individual aged 18 or over who is authorised by either the licence holder or designated premises supervisor. For premises with a club premises certificate, any member or officer of the club present on the premises in a capacity that which enables him to prevent the supply of alcohol.

9. Admission of children to the premises must be restricted in accordance with the film classification recommended by the British Board of Film Classification or recommended by this licensing authority as appropriate.

Annex 2 – Conditions consistent with the operating Schedule

None

Annex 3 – Conditions attached after a hearing by the licensing authority

10. Persons under the age of 20 shall not be admitted as members.
11. Films shall be ancillary (background) to other licensable activities.
12. Patrons waiting for taxi shall wait in the lobby of the premises.
13. Substantial food and suitable beverages other than intoxicating liquor (including drinking water) shall be available during the whole of the permitted hours in all parts of the premises where intoxicating liquor is sold or supplied.
14. The premises will maintain a comprehensive CCTV system that ensures all areas of the licensed premises are monitored including all entry and exit points, and the street environment and which enable frontal identification of every person entering in any light condition. All cameras shall continually record whilst the premises are open to the public and the video recordings shall be kept available for a minimum of 31 days with time and date stamping. (ii) Tape recordings shall be made available to an authorised officer or a police officer together with facilities for viewing. (iii) The recordings for the preceding two days shall be made available immediately on request. Recordings outside this period shall be made available on 24 hours notice. (Subject to the Data Protection Act 1998).
15. No striptease, no nudity and all persons on the premises to be decently attired.
16. No gaming otherwise than by machines authorised under part III, Gaming Act, 1968.
17. There shall be no payment made by or on behalf of the licensees to any person for bringing customers to the premises off the street.
18. Noise and vibration will not be allowed to emanate from the premises so as to cause a nuisance to nearby properties.
19. There shall be no speakers, amplification or live entertainment to take place within the front lobby of the premises.
20. The door from the entrance lobby to the remainder of the premises shall not be fixed open after 23:00.
21. A sound limiting device must be fitted to the musical amplification system set at a level determined by and to the satisfaction of an authorised officer of the Environmental Health Service's Community Protection Department so as to ensure that no noise nuisance is caused to local residents. The operational panel of the noise limiter shall then be secured to the satisfaction of officers from the Environmental Health Service. The keys securing the noise limiter cabinet shall be held by the applicant only, and shall not be accessed by any other person. The limiter shall not be altered without prior agreement with the Environmental Health Service.
22. No alteration or modification to any existing sound system(s) should be effected without prior knowledge of an authorised Officer of the Environmental Health Services.
23. Any additional sound generating equipment shall not be used on the premises without being routed through the sound limiter device.
24. Notices will be prominently displayed at exits requesting the public to respect the needs of local residents and to leave the premises and the area quietly.

25. The number of persons accommodated (excluding staff) at the premises shall not exceed Basement - 356, and Ground Floor - 117.
26. Arrangements will be made to ensure that any capacity limit set for the premises can be properly monitored. Information regarding the capacity should be given to an authorised officer on request.
27. After 23:00 hours the supply of alcohol shall be ancillary to the use of the premises for music and dancing and substantial refreshment.
28. No person shall give at the premises any exhibition, demonstration or performance of hypnotism, mesmerism or any similar act or process which produces or is intended to produce in any other person any form of induced sleep or trance in which susceptibility of the mind of that person to suggestion or direction is increased or intended to be increased.

NOTE: (1) This rule does not apply to exhibitions given under the provisions of Section 2(1A) and 5 of the Hypnotism Act 1952.

29. The approved arrangements at the premises, including means of escape provisions, fire warning and fire fighting equipment, the electrical installation and mechanical equipment, shall at all material times be maintained in good condition and full working order.
30. The certificates listed below shall be made available to the Licensing Authority upon written request.
 - Any emergency lighting battery or system certificate
 - Any electrical installation certificate
 - Any fire alarm system certificate
31. The means of escape provided for the premises shall be maintained unobstructed, free of trip hazards, be immediately available and clearly identified in accordance with the plans provided.
32. No changes shall be made to the approved layout of the premises without the consent of the Licensing Authority.
33. All exit doors shall be available at all material times without the use of a key, code, card or similar means.
34. All fire doors shall be maintained effectively self closing and not held open other than by an approved device.
35. Fire resisting doors to ducts, service shafts and cupboards shall be kept locked shut.
36. The edges of the treads of steps and stairways shall be maintained so as to be conspicuous.
37. Only hangings, curtains, upholstery and temporary decorations, complying with the relevant British (or where appropriate European) Standard shall be used. Where necessary these shall be periodically tested for flame resistance and re-treated as necessary.
38. Curtains and hangings shall be arranged so as not to obstruct fire safety signs, fire extinguishers or other fire fighting equipment.
39. Staff with specific responsibilities in the event of fire or other emergency, together with deputies, shall receive training and written instruction appropriate to their role.

40. The flue of any boiler or heating appliance shall be professionally cleaned at intervals not less than the minimum recommended by the appliance manufacturer.
41. Ventilation ducting and shafts generally shall be maintained in a clean condition.
42. All interior surfaces of extract ventilation ducting serving kitchens and serveries shall be thoroughly cleaned at least annually.
43. Any special effects or mechanical installations shall be arranged and stored so as to minimise any risk to the safety of those using the premises. The following special effects will only be used on 5 working days prior notice being given to the Council where consent has not previously been given.
 - dry ice and cryogenic fog
 - smoke machines and fog generators
 - pyrotechnics including fire works
 - firearms
 - lasers
 - explosives and highly flammable substances.
 - real flame.
 - Strobe lighting.
44. Children shall only be admitted for private events and table meals if accompanied by an adult.
45. Flashing or particularly bright lights on or outside the premises will not be permitted to cause a nuisance to nearby properties (save insofar as they are necessary for the prevention of crime).
46. All waste is to be properly presented and placed out for collection no earlier than 30 minutes before the scheduled collection times.
47. The Licence will have no effect until the premises is assessed as satisfactory by the Environmental Health Consultation Team.
48. Before the premises open to the public, the plans as deposited should be checked to ensure they are an accurate reflection of the premises constructed. Where the premises layout changes during the course of construction, new plans shall be provided to the Licensing Authority.







Annex 4 – Plans

Attached

MAP 1

17 BERKELEY ST

KEY:

-  FIRE EXIT SIGN (ARROW)
-  WATER EXTINGUISHERS
-  FOAM EXTINGUISHERS
-  CHEMICAL EXTINGUISHERS
-  FIRE BLANKET
-  FIRE DOOR



BERKELEY STREET

2 GROUND FLOOR BERKELEY STREET



3 BASEMENT FLOOR BERKELEY STREET

MARK FINNEY ASSOCIATES ARCHITECTS • PLANNERS
 17 BERKELEY STREET
 BERKELEY, CA 94704
 TEL: 415.874.1774
 FAX: 415.874.1775
 WWW: WWW.MARKFINNEY.COM

17 BERKELEY STREET
 001. 008

24-HR LIQUOR LICENSE APPLICATION
 DATE: 10/15/2014
 TIME: 10:00 AM
 BY: [Signature]
 FOR: [Signature]



Schedule 12
Part B

WARD: West End
UPRN: 010033540857

City of Westminster
64 Victoria Street, London, SW1E 6QP

**Premises licence
summary**

Regulation 33, 34

Premises licence number:

13/05090/LIPDPS

Part 1 – Premises details

Postal address of premises:

Manray
Basement And Ground Floor
17 Berkeley Street
London
W1J 8EA

Telephone Number: 0207 025 8332

Where the licence is time limited, the dates:

Not applicable

Licensable activities authorised by the licence:

Performance of Dance
Provision of facilities for Dancing
Exhibition of a Film
Provision of facilities for making Music
Performance of Live Music
Playing of Recorded Music
Provision of facilities for entertainment of a similar description to making music or dancing
Anything of a similar description to Live Music, Recorded Music or Performance of Dance
Late Night Refreshment
Sale by Retail of Alcohol

The times the licence authorises the carrying out of licensable activities:

Performance of Dance

| | |
|---------------------|---------------------------|
| Monday to Thursday: | 09:00 to 23:30 (Basement) |
| Friday to Saturday: | 09:00 to 00:00 (Basement) |
| Sunday: | 09:00 to 22:30 (Basement) |

Provision of facilities for Dancing

| | |
|---------------------|---------------------------|
| Monday to Thursday: | 09:00 to 23:30 (Basement) |
| Friday to Saturday: | 09:00 to 00:00 (Basement) |
| Sunday: | 09:00 to 22:30 (Basement) |

Exhibition of a Film

| | |
|---------------------|---|
| Monday to Thursday: | 09:00 to 23:30 (Basement and Ground Floors) |
| Friday to Saturday: | 09:00 to 00:00 (Basement and Ground Floors) |

| | |
|--|---|
| Sunday: | 09:00 to 22:30 (Basement and Ground Floors) |
| Provision of facilities for making Music | |
| Monday to Thursday: | 09:00 to 23:30 (Basement) |
| Friday to Saturday: | 09:00 to 00:00 (Basement) |
| Sunday: | 09:00 to 22:30 (Basement) |
| Performance of Live Music | |
| Monday to Thursday: | 09:00 to 23:30 (Basement) |
| Friday to Saturday: | 09:00 to 00:00 (Basement) |
| Sunday: | 09:00 to 22:30 (Basement) |
| Playing of Recorded Music | |
| Monday to Thursday: | 09:00 to 23:30 (Basement and Ground Floors) |
| Friday to Saturday: | 09:00 to 00:00 (Basement and Ground Floors) |
| Sunday: | 09:00 to 22:30 (Basement and Ground Floors) |
| Provision of facilities for entertainment of a similar description to making music or dancing | |
| Monday to Thursday: | 09:00 to 23:30 (Basement) |
| Friday to Saturday: | 09:00 to 00:00 (Basement) |
| Sunday: | 09:00 to 22:30 (Basement) |
| Anything of a similar description to Live Music, Recorded Music or Performance of Dance | |
| Monday to Thursday: | 09:00 to 23:30 (Basement) |
| Friday to Saturday: | 09:00 to 00:00 (Basement) |
| Sunday: | 09:00 to 22:30 (Basement) |
| Late Night Refreshment | |
| Monday to Thursday: | 23:00 to 23:30 (Basement and Ground Floors) |
| Friday to Saturday: | 23:00 to 00:00 (Basement and Ground Floors) |
| Sale by Retail of Alcohol | |
| Monday to Thursday: | 10:00 to 23:30 (Basement and Ground Floors) |
| Friday to Saturday: | 10:00 to 00:00 (Basement and Ground Floors) |
| Sunday: | 12:00 to 22:30 (Basement and Ground Floors) |

| | |
|---|----------------|
| The opening hours of the premises: | |
| Monday to Sunday: | 07:00 to 06:00 |

| | |
|--|--|
| Where the licence authorises supplies of alcohol, whether these are on and/or off supplies: | |
| Alcohol is supplied for consumption both on and off the Premises. | |

| | |
|---|--|
| Name and (registered) address of holder of premises licence: | |
| Blake Trading Limited 12 Princes Street London W1B 2LL | |

Registered number of holder, for example company number, charity number (where applicable)

07902469

Name of designated premises supervisor where the premises licence authorises for the supply of alcohol:

Name: Mr Mark Belton

State whether access to the premises by children is restricted or prohibited:

Restricted

Date: 26 July 2013

Signed: pp

Operational Director - Premises Management

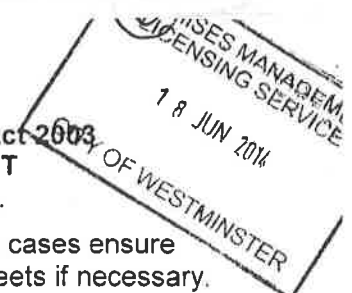

Application to vary a premises licence under the Licensing Act 2003
PLEASE READ THE FOLLOWING INSTRUCTIONS FIRST

Before completing this form please read the guidance notes at the end of the form.

If you are completing this form by hand please write legibly in block capitals. In all cases ensure that your answers are inside the boxes and written in black ink. Use additional sheets if necessary.

You may wish to keep a copy of the completed form for your records.

I/We **Park Chinois Limited**

(Insert name(s) of applicant)

being the premises licence holder, apply to vary a premises licence under section 34 of the Licensing Act 2003 for the premises described in Part 1 below

| |
|--|
| Premises licence number 13/05974/LIPVM |
|--|

Part 1 – Premises Details

| | | | |
|--|--------|------------------|---------|
| Postal address of premises or, if none, ordnance survey map reference or description 33 Dover Street | | | |
| Post town | London | Post code | W1S 4NF |

| | |
|---|---------|
| Telephone number at premises (if any) | |
| Non-domestic rateable value of premises | £78,000 |

Part 2 – Applicant details

| | | | |
|--|---|-----------------|---------|
| Daytime contact telephone number | c/o 020 7339 7010 | | |
| E-mail address (optional) | ajc@jgrlaw.co.uk | | |
| Current postal address if different from premises address | c/o Jeffrey Green Russell Limited Waverley House 7-12 Noel Street | | |
| Post Town | London | Postcode | W1F 8GQ |

Part 3 - Variation

Do you want the proposed variation to have effect as soon as possible?

Yes

No

If not do you want the variation to take effect from

Day Month Year

Please describe briefly the nature of the proposed variation (Please see guidance note 1)

The applicant has recently acquired both 33 Dover Street (Licence currently numbered 13/05974/LIVPM) and 17 Berkeley Street (Licence currently numbered 13/05090/LIPDPS).

The applicant is proposing to move the majority of the business activity away from 33 Dover Street to 17 Berkeley Street. To do this the applicant is seeking the following:-

- 1) To remove the basement from the licence by amending the plans and removing all licensable activities associated with the basement (only to take effect on surrender of licence currently numbered 13/05090/LIPDPS). The basement will effectively become a back of house area.
- 2) Reduce the capacity figure for the ground floor from from 180 persons to 120 persons (only to take effect on surrender of licence currently numbered 13/05090/LIPDPS) .
- 3) To amend/remove the conditions as proposed in the application to effect the above (only to take effect on surrender of licence currently numbered 13/05090/LIPDPS).
- 4) Vary the ground floor plan to take immediate effect on the grant of this application. Namely to keep the existing counter in the same location and reconfiguring the seating layout and such other changes as set out on the plan. Further a new acoustic lobby has been created. A minor variation to accommodate these changes and others was recently granted by Westminster City Council. The applicant however has scaled back these plans.

The applicant will consider such other changes as necessary. The applicant has sought pre-application advice with Ian Watson and Mr Alan Lynagh. Please note licence 13/05090/LIPDPS relates to 17 Berkeley Street and a new licence application has been submitted for this premises.

If your proposed variation would mean that 5,000 or more people are expected to attend the premises at any one time, please state the number expected to attend

n/a

Part 4 Operating Schedule

Please complete those parts of the Operating Schedule below which would be subject to change if this application to vary is successful.

Provision of regulated entertainment

Please tick yes

- a) plays (if ticking yes, fill in box A)
- b) films (if ticking yes, fill in box B)
- c) indoor sporting events (if ticking yes, fill in box C)
- d) boxing or wrestling entertainment (if ticking yes, fill in box D)
- e) live music (if ticking yes, fill in box E)
- f) recorded music (if ticking yes, fill in box F)
- g) performances of dance (if ticking yes, fill in box G)
- h) anything of a similar description to that falling within (e), (f) or (g) (if ticking yes, fill in box H)

Provision of late night refreshment (if ticking yes, fill in box I)

Sale by retail of alcohol (if ticking yes, fill in box J)

In all cases complete boxes K, L and M

A

| | | | | | |
|---|--------------|---------------|--|----------|--------------------------|
| Plays Standard days and timings (please read guidance note 6) | | | Will the performance of a play take place indoors or outdoors or both – please tick (please read guidance note 2) | Indoors | <input type="checkbox"/> |
| | | | | Outdoors | <input type="checkbox"/> |
| | | | | Both | <input type="checkbox"/> |
| Day | Start | Finish | Please give further details here (please read guidance note 3) | | |
| Mon | | | | | |
| Tue | | | | | |
| Wed | | | State any seasonal variations for performing plays (please read guidance note 4) | | |
| Thur | | | | | |
| Fri | | | Non standard timings. Where you intend to use the premises for the performance of plays at different times to those listed in the column on the left, please list (please read guidance note 5) | | |
| Sat | | | | | |
| Sun | | | | | |

B

| | | | | | |
|---|--------------|---------------|---|----------|--------------------------|
| Films Standard days and timings (please read guidance note 6) | | | Will the exhibition of films take place indoors or outdoors or both – please tick (please read guidance note 2) | Indoors | <input type="checkbox"/> |
| | | | | Outdoors | <input type="checkbox"/> |
| | | | | Both | <input type="checkbox"/> |
| Day | Start | Finish | Please give further details here (please read guidance note 3) | | |
| Mon | | | | | |
| Tue | | | State any seasonal variations for the exhibition of films (please read guidance note 4) | | |
| Wed | | | | | |
| Thur | | | Non standard timings. Where you intend to use the premises for the exhibition of films at different times to those listed in the column on the left, please list (please read guidance note 5) | | |
| Fri | | | | | |
| Sat | | | | | |
| Sun | | | | | |

C

| | | | |
|--|-------|--------|---|
| Indoor sporting events Standard days and timings (please read guidance note 6) | | | Please give further details (please read guidance note 3) |
| Day | Start | Finish | |
| Mon | | | State any seasonal variations for indoor sporting events (please read guidance note 4) |
| Tue | | | |
| Wed | | | |
| Thur | | | Non standard timings. Where you intend to use the premises for indoor sporting events at different times to those listed in the column on the left, please list (please read guidance note 5) |
| Fri | | | |
| Sat | | | |
| Sun | | | |

D

| | | | | | |
|--|-------|--------|---|----------|--------------------------|
| Boxing or wrestling entertainments Standard days and timings (please read guidance note 6) | | | Will the boxing or wrestling entertainment take place indoors or outdoors or both – please tick (please read guidance note 2) | Indoors | <input type="checkbox"/> |
| | | | | Outdoors | <input type="checkbox"/> |
| | | | | Both | <input type="checkbox"/> |
| Day | Start | Finish | | | |
| Mon | | | Please give further details here (please read guidance note 3) | | |
| | | | | | |
| Tue | | | State any seasonal variations for boxing or wrestling entertainment (please read guidance note 4) | | |
| | | | | | |
| Wed | | | | | |
| Thur | | | | | |
| Fri | | | Non standard timings. Where you intend to use the premises for boxing or wrestling entertainment at different times to those listed in the column on the left, please list (please read guidance note 5) | | |
| Sat | | | | | |
| Sun | | | | | |

E

| | | | | | |
|--|--------------|---------------|---|----------|--------------------------|
| Live music Standard days and timings (please read guidance note 6) | | | Will the performance of live music take place indoors or outdoors or both – please tick (please read guidance note 2) | Indoors | <input type="checkbox"/> |
| | | | | Outdoors | <input type="checkbox"/> |
| | | | | Both | <input type="checkbox"/> |
| Day | Start | Finish | Please give further details here (please read guidance note 3) | | |
| Mon | | | | | |
| Tue | | | State any seasonal variations for the performance of live music (please read guidance note 4) | | |
| Wed | | | | | |
| Thur | | | Non standard timings. Where you intend to use the premises for the performance of live music at different times to those listed in the column on the left, please list (please read guidance note 5) | | |
| Fri | | | | | |
| Sat | | | | | |
| Sun | | | | | |

F

| | | | | | |
|--|-------|--------|---|----------|--------------------------|
| Recorded music Standard days and timings (please read guidance note 6) | | | Will the playing of recorded music take place indoors or outdoors or both – please tick (please read guidance note 2) | Indoors | <input type="checkbox"/> |
| | | | | Outdoors | <input type="checkbox"/> |
| Day | Start | Finish | | Both | <input type="checkbox"/> |
| Mon | | | Please give further details here (please read guidance note 3) | | |
| Tue | | | | | |
| Wed | | | State any seasonal variations for the playing of recorded music (please read guidance note 4) | | |
| Thur | | | | | |
| Fri | | | Non standard timings. Where you intend to use the premises for the playing of recorded music at different times to those listed in the column on the left, please list (please read guidance note 5) | | |
| Sat | | | | | |
| Sun | | | | | |

G

| | | | | | |
|---|--------------|---------------|--|----------|--------------------------|
| Performances of dance Standard days and timings (please read guidance note 6) | | | Will the performance of dance take place indoors or outdoors or both – please tick (please read guidance note 2) | Indoors | <input type="checkbox"/> |
| | | | | Outdoors | <input type="checkbox"/> |
| | | | | Both | <input type="checkbox"/> |
| Day | Start | Finish | Please give further details here (please read guidance note 3) | | |
| Mon | | | | | |
| Tue | | | State any seasonal variations for the performance of dance (please read guidance note 4) | | |
| Wed | | | | | |
| Thur | | | Non standard timings. Where you intend to use the premises for the performance of dance at different times to those listed in the column on the left, please list (please read guidance note 5) | | |
| Fri | | | | | |
| Sat | | | | | |
| Sun | | | | | |

H

| | | | | | |
|--|-------|--------|---|----------|--------------------------|
| Anything of a similar description to that falling within (e), (f) or (g) Standard days and timings (please read guidance note 6) | | | Please give a description of the type of entertainment you will be providing | | |
| Day | Start | Finish | Will this entertainment take place indoors or outdoors or both – please tick (please read guidance note 2) | Indoors | <input type="checkbox"/> |
| Mon | | | | Outdoors | <input type="checkbox"/> |
| | | | | Both | <input type="checkbox"/> |
| Tue | | | Please give further details here (please read guidance note 3) | | |
| Wed | | | | | |
| Thur | | | State any seasonal variations for entertainment of a similar description to that falling within (e), (f) or (g) (please read guidance note 4) | | |
| Fri | | | | | |
| Sat | | | Non standard timings. Where you intend to use the premises for the entertainment of a similar description to that falling within (e), (f) or (g) at different times to those listed in the column on the left, please list (please read guidance note 5) | | |
| Sun | | | | | |

| | | | | | |
|--|--------------|---------------|--|----------|--------------------------|
| Late night refreshment Standard days and timings (please read guidance note 6) | | | Will the provision of late night refreshment take place indoors or outdoors or both – please tick (please read guidance note 2) | Indoors | <input type="checkbox"/> |
| | | | | Outdoors | <input type="checkbox"/> |
| | | | | Both | <input type="checkbox"/> |
| Day | Start | Finish | Please give further details here (please read guidance note 3) | | |
| Mon | | | | | |
| Tue | | | State any seasonal variations for the provision of late night refreshment (please read guidance note 4) | | |
| Wed | | | | | |
| Thur | | | Non standard timings. Where you intend to use the premises for the provision of late night refreshment at different times, to those listed in the column on the left, please list (please read guidance note 5) | | |
| Fri | | | | | |
| Sat | | | | | |
| Sun | | | | | |

J

| | | | | | |
|--|-------|--------|---|---------------------|--------------------------|
| Supply of alcohol Standard days and timings (please read guidance note 6) | | | Will the supply of alcohol be for consumption (Please tick box) (please read guidance note 7) | On the premises | <input type="checkbox"/> |
| | | | | Off the premises | <input type="checkbox"/> |
| | | | | Both | <input type="checkbox"/> |
| Day | Start | Finish | State any seasonal variations for the supply of alcohol (please read guidance note 4) | | |
| Mon | | | | | |
| Tue | | | | | |
| Wed | | | | | |
| Thur | | | | | |
| Fri | | | | | |
| Sat | | | | | |
| Sun | | | | | |
| | | | Non-standard timings. Where you intend to use the premises for the supply of alcohol at different times to those listed in the column on the left, please list (please read guidance note 5) | | |

K

Please highlight any adult entertainment or services, activities, other entertainment or matters ancillary to the use of the premises that may give rise to concern in respect of children (please read guidance note 8)

None

L

| | | | |
|--|-------|--------|--|
| Hours premises are open to the public Standard days and timings (please read guidance note 6) | | | State any seasonal variations (please read guidance note 4) No change from existing licence |
| Day | Start | Finish | |
| Mon | | | Non standard timings. Where you intend the premises to be open to the public at different times from those listed in the column on the left, please list (please read guidance note 5) |
| | | | |
| Tue | | | |
| | | | |
| Wed | | | |
| | | | |
| Thur | | | |
| | | | |
| Fri | | | |
| | | | |
| Sat | | | |
| | | | |
| Sun | | | |
| | | | |

Please identify those conditions currently imposed on the licence which you believe could be removed as a consequence of the proposed variation you are seeking

The applicant seeks to amend the conditions on the licence as follows:-

- 1) Remove conditions 12, 22, 23, 24, 26, 27, 28 (only to take effect on surrender of licence 13/05090/LIPDPS).
- 2) Amend Condition 16 to the following:-

"The number of customers accommodated at any time (excluding staff) shall not exceed: Ground floor [120] customers"

(only to take effect on surrender of licence 13/05090/LIPDPS).
- 3) Such other changes to conditions as the committee agree or as may be agreed with interested parties (only to take effect on surrender of licence 13/05090/LIPDPS).

Please tick yes

- I have enclosed the premises licence
- I have enclosed the relevant part of the premises licence

If you have not ticked one of these boxes please fill in reasons for not including the licence, or part of it, below

Reasons why I have failed to enclose the premises licence or relevant part of premises licence

M Describe any additional steps you intend to take to promote the four licensing objectives as a result of the proposed variation:

a) General – all four licensing objectives (b,c,d,e) (please read guidance note 9)

Conditions are already in place and the applicant is seeking to reduce the scope of the licence

b) The prevention of crime and disorder

Conditions are already in place and the applicant is seeking to reduce the scope of the licence

c) Public safety

Conditions are already in place and the applicant is seeking to reduce the scope of the licence

d) The prevention of public nuisance

Conditions are already in place and the applicant is seeking to reduce the scope of the licence

e) The protection of children from harm

Conditions are already in place and the applicant is seeking to reduce the scope of the licence

Please tick yes

- I have made or enclosed payment of the fee
- I have sent copies of this application and the plan to responsible authorities and others where applicable
- I understand that I must now advertise my application
- I have enclosed the premises licence or relevant part of it or explanation
- I understand that if I do not comply with the above requirements my application will be rejected

IT IS AN OFFENCE, LIABLE ON SUMMARY CONVICTION TO A FINE UP TO LEVEL 5 ON THE STANDARD SCALE, UNDER SECTION 158 OF THE LICENSING ACT 2003, TO MAKE A FALSE STATEMENT IN OR IN CONNECTION WITH THIS APPLICATION

Part 5 – Signatures (please read guidance note 10)

Signature of applicant (the current premises licence holder) or applicant’s solicitor or other duly authorised agent (please read guidance note 11). If signing on behalf of the applicant please state in what capacity.

| | |
|-----------|--|
| Signature | <i>Jeffrey Green Russell Limited</i> |
| Date | 18 June 2014 |
| Capacity | Solicitors acting as agents for and on behalf of the Applicant |

Where the premises licence is jointly held signature of 2nd applicant (the current premises licence holder) or 2nd applicant’s solicitor or other authorised agent (please read guidance note 12). If signing on behalf of the applicant please state in what capacity.

| | |
|-----------|--|
| Signature | |
| Date | |
| Capacity | |

Contact name (where not previously given) and address for correspondence associated with this application (please read guidance note 13)

Andrew Wong
 Jeffrey Green Russell Limited
 Waverley House
 7-12 Noel Street

| | | | |
|--|---------------|------------------|---------|
| Post town | London | Post code | W1F 8GQ |
| Telephone number (if any) | 020 7339 7067 | | |
| If you would prefer us to correspond with you by e-mail your e-mail address (optional) copy correspondence only aww@jgrlaw.co.uk | | | |

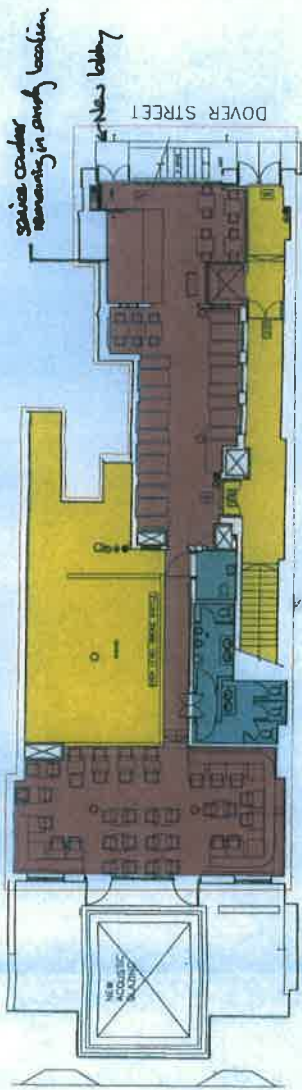

sales center remaining in same location

new lobby

DOVER STREET

1 PROPOSED DOVER STREET GROUND FLOOR PLAN

Licensable activities may take place anywhere within the red line. The position of any loose furniture is shown for diagrammatic purpose only. The location of fire equipment is shown as is on the date hereof but may be moved in consultation with the fire officer.

Dated 18/05/14.

- KEY:
- NEW LICENSABLE ACTIVITIES
 - FIRE ALARMS
 - FIRE EXTINGUISHERS
 - FIRE EXTINGUISHERS
 - FIRE EXTINGUISHERS
 - FIRE EXTINGUISHERS

ARCHITECT: [REDACTED] LIMITED
 1811 644 644 E [REDACTED]@architect.com
 DOVER STREET
 ALL PROPOSED PLANS
 EXCLUDING DRAWINGS
 1383.08.04.01

This document is the property of [REDACTED] and is not to be distributed, copied, or used in any way without the written consent of [REDACTED]. It is intended for the use of the client and is not to be used for any other purpose. All rights reserved.

Peermamode, Ryan

From: Deweltz, Adam
Sent: 16 July 2014 14:15
To: aww@jgrlaw.co.uk
Cc: idoxlicensing; Sollars, Jim
Subject: Automat, 33 Dover Street, W1S 4NF - 14/05061/LIPV

Dear Andrew,

Automat, 33 Dover Street, W1S 4NF - 14/05061/LIPV

With reference to the above application, I am writing to inform you that the Metropolitan Police, as a Responsible Authority, will be objecting to this application:

It is our belief that if granted the application would undermine the Licensing Objectives in relation to the prevention of crime and disorder and a public nuisance, as there are insufficient conditions contained within the operating schedule.

Many thanks,

Adam

PC Adam Deweltz
Westminster Police Licensing Unit
Westminster City Hall
4th Floor
64 Victoria Street
London
SW1E 6QP

CITY OF WESTMINSTER

MEMORANDUM

TO Licensing Officer

REFERENCE 14/05061/LIPV

FROM EH Consultation Team

REFERENCE

BEING DEALT WITH BY Ian Watson (iwatson@westminster.gov.uk)

TELEPHONE 020 7641 3183

DATE 16th July 2014

The Licensing Act 2003

Park Chinois, 33 Dover St, W1

I refer to the application for a variation of the Premises Licence 13/05974/LIPVM.

The applicant has submitted floor plans of the premises ref 1303.DB.04.01 dated 5/11/13.

This representation is based on the plans and operating schedule submitted.

The applicant is seeking the following

1. To remove the basement and associated licensable activities from the licence by amending the plans.
2. To reduce the capacity figure for the ground floor from 180 persons to 120 persons.
3. To vary the ground floor with regard to reconfiguration of the seating, new acoustic entrance lobby and other changes as set out on the plan.
4. To remove conditions 12.22.23.24.26.27 and 28 from the licence
5. To amend condition 16 to read,
 - The number of customers accommodated at any one time (excluding staff) shall not exceed Ground Floor 120 customers.

I wish to make the following representation

1. The amendments to the plans, changes to the premises and capacities, removal of conditions and amendment of conditions will have the likely effect of causing an increase in Public Nuisance within the area and impact on Public Safety.

The granting of the application as presented would have the likely effect of causing an increase in Public Nuisance and impact on Public Safety within the area.

The applicant has stated that the variation will only take effect on surrender of licence number 13/05090/LIPDPS.

The applicant has provided additional information along with proposed conditions with the application which is being considered but do not fully address the concerns of Environmental Health.

Should you wish to discuss the matter further please do not hesitate to contact me.

Ian Watson
Senior Practitioner Environmental Health (Licensing)

Peermamode, Ryan

From: Tim Howden [tshowden@btinternet.com]
Sent: 06 July 2014 14:14
To: Premises Licensing
Cc: jaleh.zand@gmail.com
Subject: License for dance and music until 3.30am 17 Berkeley Street and 17 Dover Street. Ref application number 14/05048/LIPN Post Code W1J 8EA

Follow Up Flag: Follow up
Flag Status: Completed

I am a resident in Hay Hill in Flat 72 Berkeley House. I wish to register the strongest possible objection to this application for a night club running between 17 Berkeley Street and 33 Dover Street with a capacity for 450! Your grant of licences for restaurants with music licenses and night clubs in Berkeley and Dover Street appears to be without any interest in their impact on your residents or balance in this tight area. Four new restaurant licenses in a year all one after another applying for music licenses and now this huge night club for 450 running under residential buildings across the block and coming on top of the relicensed Rififi playing music at a level totally unacceptable volume for the residents sleeping above it in Berkeley House.

Please do give careful thought to what you will be imposing on on residents with approval on this scale with "The 450" at maximum volume".

With kindest regards
Tim Howden

Peermamode, Ryan

Subject: FW: FW: Objection to licence applications for 33 Dover and 17 Berkeley Street

From: Cedric Marceu [<mailto:cedric.marceu@gmail.com>]

Sent: 06 August 2014 10:04

To: Qureshi, Sabihah

Cc: aww@jgrlaw.co.uk

Subject: Re: FW: Objection to licence applications for 33 Dover and 17 Berkeley Street

Thank you for your email.

Alan Yau's team has engaged with me and I had an opportunity to discuss my concerns. As a result I would like to withdraw my objections to his licensing application.

Kind regards

From: Cedric Marceu [<mailto:cedric.marceu@gmail.com>]

Sent: 16 July 2014 17:18

To: Patterson, Susan; Premises Licensing

Subject: Objection to licence applications for 33 Dover and 17 Berkeley Street

Dear Sirs

Re: License applications for 33 Dover Street and 17 Berkeley Street

I am writing as a Mayfair resident at Flat 5, 17 Brooks Mews, W1K4DT.

I trust that the counsel will rule on this application keeping in mind that Mayfair is one of the finest London neighbourhoods. Residents already face serious challenges given the proliferation and commercial success of late night venues. If anything existing licenses should be reviewed! I object strongly on the grounds of preventing public nuisance and crime and disorder.

Thank you for considering this and I look forward to hear from you.

Kind regards

Cedric Marceu

Peermamode, Ryan

Subject: FW: FW: Licensing Objection

From: James Flennigan [mailto:jamesflennigan@gmail.com]

Sent: 28 August 2014 17:45

To: Qureshi, Sabihah

Cc: aww@jgrlaw.co.uk

Subject: Re: FW: Licensing Objection

Thank you.

Having learned more about the proposed venue I am withdrawing my objections.

Kind regards

James

From: James Flennigan [mailto:jamesflennigan@gmail.com]

Sent: 16 July 2014 17:27

To: Patterson, Susan; Premises Licensing

Subject: Licensing Objection

Dear Sirs

I am writing to object to the licensing application for 33 Dover Street and 17 Berkeley Street as a resident at 21 Upper Brook Street, W1K7PY.

The granting of this license would clearly go against the interest of residents. Disorderly behaviour and noise disturbance are unfortunately already prominent in this part of Mayfair and a problem for residents. We do not need another late night venue to add to the problem of public nuisance and must consider measures to prevent crime and further disorder.

I will be grateful for a response and look forward to understand how this will proceed.

Sincerely

James Flennigan

Licence History

| Application | Details of Application | Date Determined | Decision |
|---|---|-----------------|--|
| 05/06832/LIPCV Conversion Variation | To convert the existing Justices On Licence, Special Hours Certificate and Weekday Music & Dancing Licence, into a Premises Licence. Variation to extend licensable hours and removed embedded restrictions. | 28.09.2005 | Granted by Licensing Sub Committee Variation to increase licensable hours refused. <i>Note: Decision appealed by the applicant. Appeal resolved by way of consent order dated 26/07/2007 to modify conditions and extend licensable hours.</i> |
| 11/09530/LIREVP Review of Premises Licence | Review of Premises Licence brought by several residents under grounds of prevention of crime & disorder and public nuisance. | 24.11.2011 | Review determined by Licensing Sub Committee – Conditions modified |
| 12/02516/LIPT Transfer | Transfer of Premises Licence from Mr Carlos Almada to Blake Trading Limited. | 28.03.2012 | Granted under Delegated Authority |
| 13/05974/LIPVM Minor Variation | To incorporate changes to the ground floor. To restrict access to basement level and temporarily reduce capacity on ground floor whilst basement toilets unavailable. | 22.08.2013 | Granted under Delegated Authority |
| 14/05061/LIPV Variation | To remove basement level from licensable area. To remove conditions associated to basement level. To incorporate changes to ground floor plan. | | Pending |

Appeal History

33 Dover Street, W1 (Automat) / 17 Berkeley Street, W1

2005 Application for conversion and variation

On 4th August 2005, application was received for the conversion and variation of a premises licence for premises known as Automat, at 33 Dover Street W1. As there were no Police objections to the conversion application the premises licence was converted as applied for.

The variation application sought:

- The removal of all embedded restrictions,

Basement

- Extension of hours for Licensable Activities
Monday – Friday 0700 – 0400
Saturday 0800 – 0400
Sunday 0900 – 0400

Ground Floor

- Monday – Friday 0700 – 0200
Saturday 0800 – 0200
Sunday – 0900 - 0100

The application received five objections. The Police lodged an objection on the basis that the variations sought would undermine the licensing objectives. The Environmental Health Consultation Team raised an objection contending that the increase in hours would have the likely effect of increasing public nuisance. Three local residents also objected to the application. Their objections were based on public nuisance in the context of noise and anti-social behaviour upon patrons leaving the premises.

On 28 September 2005, the Licensing Sub-Committee considered the application and refused it.

The decision of the Sub-Committee was duly appealed to the Magistrates' Court by the applicant, Carlos Almada. Prior to any full hearing the matter was settled on the conditions set out in the attached consent order.

2005 application for a new premises licence

On 26 September 2005 application was made for a new premises licence for 17 Berkeley Street, seeking the sale of alcohol Monday to Sunday 7am to 5am; regulated entertainment (films, live and recorded music, performance of dance, facilities for making music and facilities for dancing) 7am to 5am on each day; late night refreshment, 11pm to 5am on each day; seasonal variations to 7am on New Years Day.

The premises comprised the ground floor of 17 Berkeley Street, the basement of 17 Berkeley Street and what is in effect the basement area of 33 Dover Street. Berkeley Street runs parallel to Dover Street. However Dover Street and Berkeley Street are on different levels, so the ground floor of 17 Berkeley Street backs on to the basement of 33 Dover Street (where the applicant also operates Automat), and the basement of 17 Berkeley Street runs through into the sub-basement area of 33 Dover Street. The application received objections from Environmental Health and 8 local residents.

On 10 January 2006, the Licensing Sub-Committee considered the application granting it in part to all the activities sought, but to restrict the hours to Core Hours. The Sub-Committee also imposed a number of conditions on the licence including a restriction on the capacity so as not to exceed 356 in the Basement and 117 in the Ground Floor. The Licensing Sub-Committee heard that the applicant was undertaking substantial works on the premises and that those works were far from complete.

On 18 January 2006 Carlos Almada appealed against the decision of the Sub-Committee.

The full appeal hearing was heard before District Judge Snow at City of Westminster Magistrates' Court on Wednesday 10 and Friday 12 December 2008.

The District Judge decided that the relevant criteria set out in paragraph 2.3.2 of the City Council's 2008 policy (the Appellant having conceded for the purposes of this appeal only that this was the relevant policy to be applied) for extending hours beyond core hours had not been met. He determined that the licensing objectives would not be promoted by granting the revised application either in full, or in part. District Judge Snow therefore dismissed the appeal. Costs were later awarded in full to the City Council.

2011 application for Review

On 21 September 2011, five local residents submitted a Review of the premises licence for Automat, 33 Dover Street, W1 on the grounds of the prevention of crime and disorder and the prevention of public nuisance.

The review sought to impose a number of additional conditions on the premises licence to address issues of noise escape and disturbance.

Representations in support of the application for Review were received from the Environmental Health Consultation Team and one additional local resident. A submission was also received from the administrators of 17 Berkeley Street Limited, who were operating the premises at the time.

The application was considered by the Licensing Sub-Committee on 24 November 2011. Having heard from all parties and considered the report and submissions before them, the Sub-Committee decided to impose additional conditions on the licence.

Notice of appeal was lodged on behalf of the administrators of 17 Berkeley Street. Prior to the full hearing in the Magistrates' Court the Appellant's withdrew their appeal and paid the City Council's costs in full.

CONDITIONS CONSISTENT WITH THE OPERATING SCHEDULE AND CONDITIONS PROPOSED BY A PARTY TO THE HEARING

When determining an application for a premises licence under the provisions of the Licensing Act 2003, the licensing authority must, unless it decides to reject the application, grant the licence subject to the conditions which are indicated as mandatory in this schedule.

At a hearing the licensing authority may, in addition, and having regard to any representations received, grant the licence subject to such conditions which are consistent with the operating schedule submitted by the applicant as part of their application, or alter or omit these conditions, or add any new condition to such extent as the licensing authority considers appropriate for the promotion of the licensing objectives.

This schedule lists those conditions which are consistent with the operating schedule, or proposed as appropriate for the promotion of the licensing objectives by a responsible authority or an interested party as indicated. These conditions have not been submitted by the licensing service but reflect the positions of the applicant, responsible authority or interested party and have not necessarily been agreed.

Conditions:**Annex 1 – Mandatory conditions**

1. No supply of alcohol may be made at a time when there is no designated premises supervisor in respect of this licence.
2. No supply of alcohol may be made at a time when the designated premises supervisor does not hold a personal licence or the personal licence is suspended.
3. Every supply of alcohol under this licence must be made or authorised by a person who holds a personal licence.
4.
 - (1) The responsible person shall take all reasonable steps to ensure that staff on relevant premises do not carry out, arrange or participate in any irresponsible promotions in relation to the premises.
 - (2) In this paragraph, an irresponsible promotion means any one or more of the following activities, or substantially similar activities, carried on for the purpose of encouraging the sale or supply of alcohol for consumption on the premises in a manner which carries a significant risk of leading or contributing to crime and disorder, prejudice to public safety, public nuisance, or harm to children ;
 - (a) games or other activities which require or encourage, or are designed to require or encourage, individuals to ;
 - (i) drink a quantity of alcohol within a time limit (other than to drink alcohol sold or supplied on the premises before the cessation of the period in which the responsible person is authorised to sell or supply alcohol), or
 - (ii) drink as much alcohol as possible (whether within a time limit or otherwise);
 - (b) provision of unlimited or unspecified quantities of alcohol free or for a fixed or discounted fee to the public or to a group defined by a particular characteristic (other than any promotion or discount available to an individual in respect of alcohol for consumption at a table meal, as defined in section 159 of the Act);

- (c) provision of free or discounted alcohol or any other thing as a prize to encourage or reward the purchase and consumption of alcohol over a period of 24 hours or less;
 - (d) provision of free or discounted alcohol in relation to the viewing on the premises of a sporting event, where that provision is dependent on ;
 - (i) the outcome of a race, competition or other event or process, or
 - (ii) the likelihood of anything occurring or not occurring;
 - (e) selling or supplying alcohol in association with promotional posters or flyers on, or in the vicinity of, the premises which can reasonably be considered to condone, encourage or glamorise anti-social behaviour or to refer to the effects of drunkenness in any favourable manner.
5. The responsible person shall ensure that no alcohol is dispensed directly by one person into the mouth of another (other than where that other person is unable to drink without assistance by reason of a disability).
6. The responsible person shall ensure that free tap water is provided on request to customers where it is reasonably available.
7. (1) The premises licence holder or club premises certificate holder shall ensure that an age verification policy applies to the premises in relation to the sale or supply of alcohol.
- (2) The policy must require individuals who appear to the responsible person to be under 18 years of age (or such older age as may be specified in the policy) to produce on request, before being served alcohol, identification bearing their photograph, date of birth and a holographic mark.
8. The responsible person shall ensure that,
- (a) where any of the following alcoholic drinks is sold or supplied for consumption on the premises (other than alcoholic drinks sold or supplied having been made up in advance ready for sale or supply in a securely closed container) it is available to customers in the following measures
 - (i) beer or cider: ½ pint;
 - (ii) gin, rum, vodka or whisky: 25 ml or 35 ml; and
 - (iii) still wine in a glass: 125 ml; and
 - (b) customers are made aware of the availability of these measures.
- A responsible person in relation to a licensed premises means the holder of the premise licence in respect of the premises, the designated premises supervisor (if any) or any individual aged 18 or over who is authorised by either the licence holder or designated premises supervisor. For premises with a club premises certificate, any member or officer of the club present on the premises in a capacity that which enables him to prevent the supply of alcohol.
9. All persons guarding premises against unauthorised access or occupation or against outbreaks of disorder or against damage (door supervisors) must be licensed by the Security Industry Authority.

Conditions reproducing the effect of conditions subject to which the relevant existing licences have effect.

Conditions relating to Regulated Entertainment:

10. This licence is subject to all the former Rules of Management for Places of Public Entertainment licensed by Westminster City Council, in force from 4 September 1998 and incorporating amendments agreed by the Council on 25 October 1999, 30 June 2000, 16 January 2001 and 1 October 2001.
11. On New Year's Eve the premises can remain open for the purpose of providing regulated entertainment from the time when the provision of regulated entertainment must otherwise cease on New Year's Eve to the time when regulated entertainment can commence on New Year's Day (or until midnight on New Year's Eve where no regulated entertainment takes place on New Year's Day).

****Condition 12 requested to be removed by applicant****

12. The entertainment in the basement shall be suitable to a light, sophisticated lounge bar environment. It shall not operate as a "disco" or night club with high noise levels.
13. No additional sound generating equipment shall be used at the premises without being routed through the sound limiter device.
14. No doors giving access/egress to the premises shall be fixed open after 11pm.
15. The licensee shall use his best endeavours to discourage patrons from using unlicensed minicabs.
16. The number of persons accommodated at any one time (excluding staff) shall not exceed:
Ground Floor: 180, Basement: 100

****Condition 16 requested to be amended by applicant, to read as follows:-****

- 16a. *The number of customers accommodated at any one time (excluding staff) shall not exceed:
Ground Floor: 120.*

Conditions for Sale of Alcohol

17. Substantial food and suitable beverages other than intoxicating liquor (including drinking water) shall be available during the whole of the permitted hours in all parts of the premises where intoxicating liquor is sold or supplied.
18. A closed circuit television system shall be installed, maintained and operated correctly as specified by the Metropolitan Police Crime prevention Officer.

Conditions which reproduce the effect of any restriction imposed on the use of the premises by specified enactments.

19. The permitted hours on New Year's Eve for the sale of alcohol will extend to the start of permitted hours on the following day.
20. If any entertainment is provided for children or if an entertainment is provided at which the majority of persons attending are children, then, if the number of children attending the entertainment exceeds 100, it shall be the duty of the holder of this premises licence/club certificate:

- a) to station and keep stationed wherever necessary a sufficient number of adult attendants, properly instructed as to their duties, to prevent more children or other persons being admitted to the building, or to any part thereof, than the building or part can properly accommodate,
 - b) to control the movement of the children and other persons admitted while entering and leaving the building or any part thereof, and
 - c) to take all other reasonable precautions for the safety of the children.
21. The terminal hour for late night refreshment on New Year's Eve is extended to 05:00 on New Year's Day.

Annex 2 – Conditions consistent with the operating Schedule

****Condition 22 requested to be removed by applicant****

22. The basement currently shown cross hatched on the plan shall not be used by any customer until the licensing authority are satisfied that the premises is constructed or altered in accordance with the appropriate provisions of the District Surveyor s Association Technical Standards for Places of Entertainment and the reasonable requirements of Westminster Environmental Health Consultation Team, at which time this condition will be removed from the Licence.

****Condition 23 requested to be removed by applicant****

23. Before the basement opens to the public, the plans as deposited will be checked by premises constructed. Where the premises layout has changed during the course of construction new plans shall be provided to the Environmental Health Consultation Team and the Licensing Authority.

****Condition 24 requested to be removed by applicant****

24. Whilst the toilets in the basement are not available, the temporary capacity for the ground floor of the premises shall be reduced to 120 (excluding staff) and condition 16 shall not apply until the works condition set out in 22 above is removed.

Annex 3 – Conditions attached after a hearing by the licensing authority

Ground floor

25. Between 07:00 - 10:00 and 01:00 - 02:00 the sale and supply of alcohol shall be ancillary to persons taking a table meal.

Basement

****Condition 26 requested to be removed by applicant****

26. In the basement, between 07:00 - 10:00 and 02:00 - 03:00, alcohol will only be sold and supplied to persons attending pre-booked private events and shall be ancillary to the provision of music and dancing and substantial refreshment.

****Condition 27 requested to be removed by applicant****

27. A booking sheet for each function will be made available to the police or an authorised officer of the council upon request at the premises. The booking sheet shall record the following information as a minimum - the name of the individual who has hired the premises together with contact details, date of hiring, and purpose of the event. A guest list for each event shall be made available for inspection.

****Condition 28 requested to be removed by applicant****

28. No unauthorised advertisements of any kind (including placard, poster, sticker, flyer, picture, letter, sign or other mark) is inscribed or affixed upon the surface of the highway, or upon any building, structure, works, street furniture, tree, or any other property, or is distributed to the public, that advertises or promotes the establishment, its premises, or any of its events, facilities, goods or services.

Both floors

29. No noise shall emanate from the premises nor vibration be transmitted through the structure of the premises which gives rise to a nuisance.
30. No person under 14 shall be admitted to the premises save in the company of an adult.
31. An itemised bill shall be provided to all customers paying by credit card.
32. The SIA registered door supervisor shall at all times monitor the activity of customers who are outside the premises eg to smoke, and encourage them to return inside.
33. The SIA registered door supervisor shall at all times monitor the activity of persons leaving the premises and when appropriate remind them to respect the needs of local residents and not to loiter outside the premises.
34. No deliveries to the premises shall take place between 23:00 hours and 07:15 hours except bread between 06:30 and 07:15.
35. No refuse collections shall take place before 07:30.
36. No noise nuisance shall be caused to local residents from the operation of any plant associated with the kitchen duct/extract fan system.
37. Notices shall be clearly and prominently displayed at all exits informing customers that this is a residential area and requiring customers to leave the premises quietly and not to loiter outside the premises.
38. A sound limiting device located in a separate and remote lockable cabinet from the volume control shall be fitted to any musical amplification system and set at a level determined by and to the satisfaction of an authorised officer of the Environmental Health Service's Community Protection Department in conjunction with local residents to ensure that no noise nuisance is caused to local residents. The operational panel of the noise limiter shall then be secured to the satisfaction of officer from the Environmental Health Service. The keys securing the noise limiter cabinet shall be held by the licence holder or authorised manager only, and shall not be accessed by any other person. The limiter shall not be altered without prior agreement with the Environmental Health Service.
39. After 9pm on each day when the premises is open, at least 1 clearly identified SIA registered door supervisors shall be on duty at each entrance in use at the premises whilst the premises are open to the public.
40. There shall be no entry/re-entry to the premises after 01:00am when no Regulated Entertainment and after 2am when Regulated Entertainment is taking place.
41. All windows on all floors and external doors shall be kept closed after 9pm, or at all times when regulated entertainment is provided, except for the immediate access and egress of customers.

42. The licence holder shall enter into an agreement with a hackney carriage and/or private carriage firm to provide transport for customers, with contact numbers made readily available to customers, who will be encouraged to use such services and required to remain inside the premises while waiting for the vehicle to arrive at the premises.
43. Patrons permitted to temporarily leave and re-enter the premises eg to smoke shall be limited to a maximum of 7 persons at any one time.
44. No waste or recyclable materials, including bottles, shall be moved, removed or placed in outside areas between 23:00 hours and 07:30 hours.
45. Patrons permitted to temporarily leave and re-enter the premises eg to smoke shall not be permitted to take drinks or glass containers with them
46. Notices shall be prominently displayed in any area used for smoking requesting patrons respect the needs of local residents and use the area quietly.
47. All waste shall be properly presented and placed out for collection no earlier than 30 minutes before the scheduled collection time.
48. The pavement from the building line to the kerb edge immediately outside the premises, including gutter/channel at its junction with the kerb edge, shall be swept and/or washed daily, and litter and sweepings collected.
49. Rubber or Felt pads shall be attached to the legs / feet of all furniture in the ground floor restaurant.
50. Loudspeakers shall not be located in the entrance lobby or outside the premises building.
51. All sales of alcohol for consumption off the premises shall be in sealed containers only, and shall not be consumed on the premises or in the immediate vicinity.
52. The Premises Licence Holder shall employ the services of a competent acoustic consultant to carry out a survey of the premises to determine:
 - o Transmission of structure borne noise
 - o Noise breakout
 - o Noise transmission through building services into adjoining commercial and residential property
 - o A noise report of the findings of the survey shall be produced identifying sound insulation and sound reduction measures, conclusions, recommendations and time scales.
 - o A copy of the noise report shall be submitted to the Environmental Health Service Consultation team for comment prior to any major work being carried out.

Conditions a) and b) listed below will apply until any recommended attenuation work has been carried out and this condition has been removed from the licence.

- a) General routine cleaning of the ground floor restaurant shall only take place between the hours of 06:00 and 23:00 hours (this does not include cleaning in response to spillages and non-routine functions); no cleaning machinery to be used before 07:00.
 - b) Regulated entertainment shall not take place in the ground floor of the premises.
53. Arrangements be made by the licensee to invite local residents to meetings, not less than quarterly, to discuss issues related to the premises.

-End of existing conditions-



Automat - 33 Dover Street, W1S 4NF

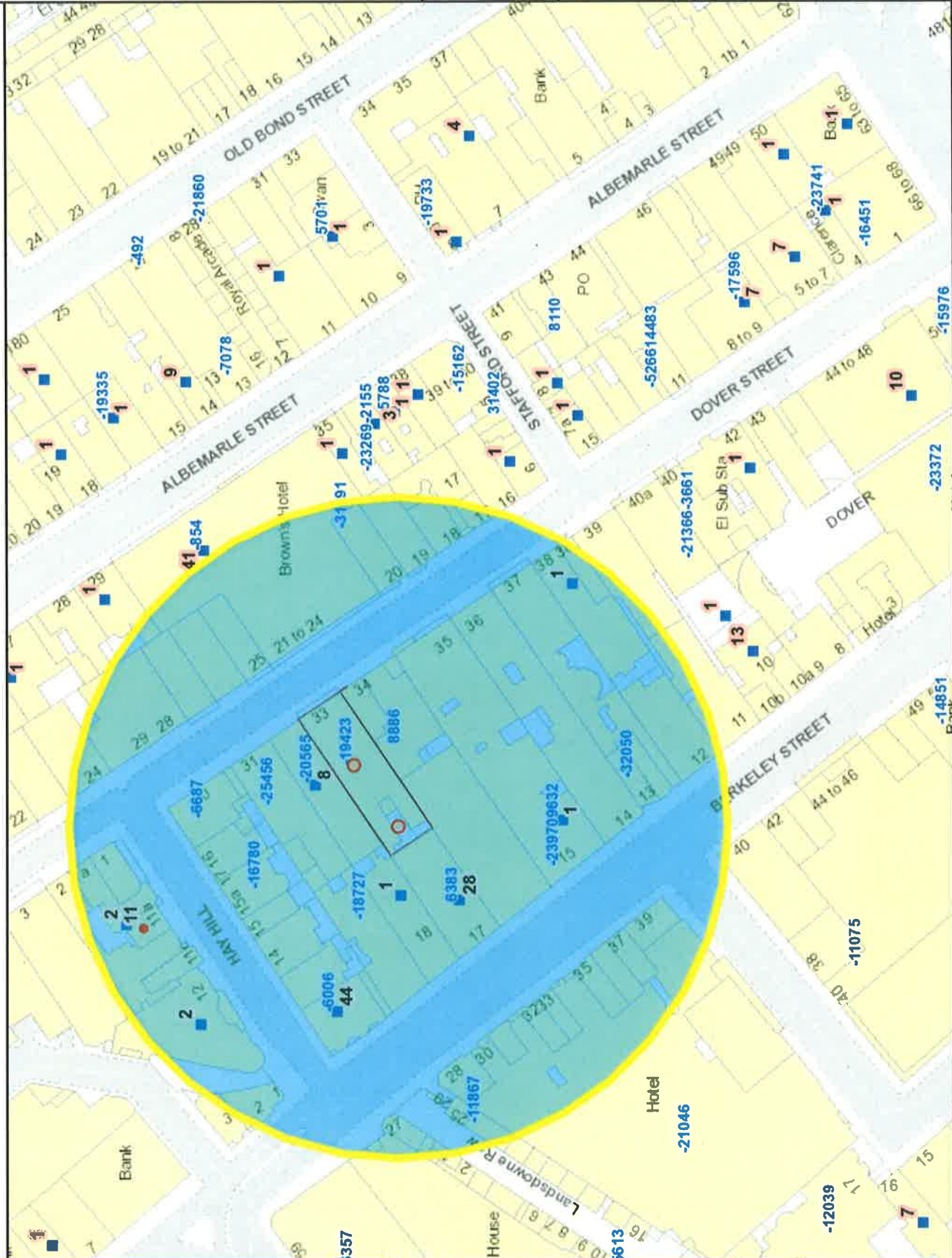

| | |
|------------------------------------|-----|
| Residential / Proposed Residential | 98 |
| Under Construction | 0 |
| Other Uses | 149 |
| Proportion Residential of all Uses | 40% |

Data Source: Uniform Database
Date: 19/09/2014

This product includes mapping data licensed from Ordnance Survey with the permission of the Controller of Her Majesty's Stationary Office. © Crown copyright and/or database right 2013. All rights reserved. Licence number 1 & 1000100007

Premises within 75 metres of: Automat - 33 Dover Street, W1S 4NF

| p / n | Name of Premises | Premises Address | Licensed Hours |
|--------------|----------------------------------|---|--|
| -19423 | Automat | Basement And Ground Floor 33 Dover Street London W1S 4NF | Monday to Friday 07:00 - 03:00 Saturday 08:00 - 03:00 Sunday 10:00 - 23:30 Sundays before Bank Holidays 10:00 - 01:00 |
| 6383 | Manray | Basement And Ground Floor 17 Berkeley Street London W1J 8EA | Monday to Sunday 07:00 - 06:00 |
| -32050 | The Fleming Collection | 13 Berkeley Street London W1J 8DU | Tuesday to Saturday 10:00 - 17:30 |
| -31191 | Alloro Restaurant | 20 Dover Street London W1S 4LR | Monday to Saturday 10:00 - 00:30 Sunday 12:00 - 00:00 |
| -25456 | Aubaine | Basement Ground Floor And Mezzanine Floor 31 Dover Street London W1S 4ND | Monday to Saturday 10:00 - 00:30 Sunday 12:00 - 00:00 |
| -23970 | Nobu Berkeley | Ground Floor 15 Berkeley Street London W1J 8DY | Monday to Saturday 09:00 - 02:30 Sunday 12:00 - 00:00 |
| -20565 | Wolf And Badger | 32 Dover Street London W1S 4NE | Monday to Thursday 09:00 - 23:30 Friday to Saturday 09:00 - 00:00 Sunday 12:00 - 22:30 |
| -18727 | Bocconcino | 19 Berkeley Street London W1J 8ED | Monday to Saturday 10:00 - 00:30 Sunday 12:00 - 22:30 |
| -16780 | Le Rififi Club | 15A Hay Hill London W1J 8NX | Monday to Saturday 09:00 - 03:30 Sunday 12:00 - 23:00 |
| -11867 | Baku | 22 - 24 Lansdowne Row London W1J 8QL | Monday to Thursday 07:00 - 00:00 Friday to Saturday 07:00 - 00:30 Sunday 07:00 - 23:00 Sundays before Bank Holidays 07:00 - 00:00 |
| -6687 | Chucs Bar & Grill | 30B Dover Street London W1S 4NB | Monday to Thursday 07:00 - 00:00 Friday to Saturday 07:00 - 00:30 Sunday 07:00 - 23:00 Sundays before Bank Holidays 07:00 - 00:00 |
| -6006 | Cafe Pushkin | 20 Berkeley Street London W1J 8EE | Monday to Wednesday 07:00 - 23:30 Thursday to Saturday 07:00 - 00:00 Sunday 08:00 - 23:00 |
| 8886 | Quattro Passi | Basement And Ground Floor Dover House 34 Dover Street London W1S 4NG | Monday to Saturday 09:00 - 01:00 Sunday 09:00 - 00:30 |
| 9632 | Funky Buddha | 15 - 16 Berkeley Street London W1J 8DY | Monday to Saturday 09:00 - 03:30 Sunday 12:00 - 23:00 |
| -21046 | Radisson Edwardian Mayfair Hotel | 17 Stratton Street London W1J 8LT | Monday to Sunday 00:00 - 00:00 (Hotel residents & their guests) Monday to Sunday 10:00 to 01:00 (Non-hotel residents) |

